

Datasheet - WKSC521



Command and signalling devices / Spring-return joystick switches WKT MKT, Maintained joystick switches WKS MKS, (C-18WKT C-47WKS) / Mounting hole \varnothing 30.5 mm / WKS - Maintained joystick switches



- Mounting hole 30.5 mm
- Mounting mounting flange
- bis 10 mm Front plate thickness
- with Locking sleeve
- 4 Contacts
- Mounting depth 57 mm
- 4 switch position

(Minor differences between the printed image and the original product may exist!)

Ordering details

Product type description	WKSC521
Article number	101019473
EAN Code	
eCl@ss	27-37-14-04

Approval

Approval

Global Properties

Permanent light	WKS Kreuzschalter
Standards	IEC/EN 60947-5-1, IEC/EN 60947-1
Compliance with the Directives (Y/N)	Yes
Suitable for safety functions (Y/N)	No
suitable for exterior use (Y/N)	Yes
Climatic stress	IEC/EN 60068-2-20
Mounting	mounting flange
Mounting position	arbitrarily
Materials	
- Material of the front ring	Aluminium - anodized

- Material of the bellows	Rubber
Material thickness of the sealing bellows	1
Color	
- Colour of the bellows	Black
- Colour of the front ring	Silver
Weight	180
Locking sleeve (Y/N)	Yes

Mechanical data

Design of electrical connection	Screw connection
Cable section	
- Min. Cable section	0,5
- Max. Cable section	2.5
Mechanical life	10.000.000 operations
Switching frequency	1200 s
notice	All indications about the cable section are including the conductor ferrules.
Actuating force	11
restistance to shock	110 / 4 - 30 / 18
Resistance to vibration	> 20 / 10 ... 200
Latching (Y/N)	Yes
Probing possible (Y/N)	No
Return to zero position (Y/N)	No
Latching position	left, right, above and bottom zero position
Number of switch positions	4
- Position A, B,C, D	
Number of directions	4
Front plate thickness	
- min. front plate thickness	1.5
- max. front plate thickness	10

Ambient conditions

Ambient temperature	
- Min. environmental temperature	-25
- Max. environmental temperature	+80
Protection class	IP65, IP67 to IEC/EN 60529
Degree of pollution	3 IEC/EN 60947-1

Electrical data

Design of control element	Normally open contact (NO) / Normally open contact (NO) / Normally open contact (NO) / Normally open contact (NO)
Switching principle	Creep circuit element
Number of auxiliary contacts	4
Number of safety contacts	0
Rated impulse withstand voltage	4
Rated insulation voltage	400
Thermal test current	10 A
Utilisation category	AC-15: 250 V / 8 A DC-13: 24 V / 5 A
Max. fuse rating	10 A gG D-fuse
- galvanically separated contact bridges	Yes
Contacts at position	
- A	1 Normally open contact (NO)

- B	1 Normally open contact (NO)
- C	1 Normally open contact (NO)
- D	1 Normally open contact (NO)
Number of switching stages	4
Number of shutters per direction	1

ATEX

Explosion protection categories for gases	None
Explosion protected category for dusts	None

Dimensions

Dimensions	
- Length of the actuator	90
- Mounting depth	57
Hole of central anchorage, diameter	31
Mounting hole IEC/EN 60947-1	30.5 + 0,5
Spacing	80 x 80

Documents

Datasheet (de) 1 MB, 15.11.2010

Code: k_krep01

Datasheet (en) 649 kB, 15.11.2010

Code: g_krep01

Mounting and wiring instructions (de, en) 183 kB, 23.01.2015

Code: m_wktp01_de-en

Declaration of conformity (de) 94 kB, 02.03.2017

Code: __krep01_de

Declaration of conformity (en) 91 kB, 06.03.2017

Code: __krep01_en

Brochure (de) 80 MB, 07.02.2012

Code: b_krep01_de

Brochure (de) 1 MB, 09.07.2012

Code: b_krep01_de

Brochure (en) 1 MB, 09.07.2012

Code: b_krep01_en

Brochure (pt) 1 MB, 09.07.2012

Code: b_krep01_pt

Brochure (es) 1 MB, 09.07.2012

Code: b_krep01_es

Images

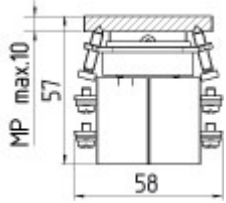

Dimensional drawing (miscellaneous)

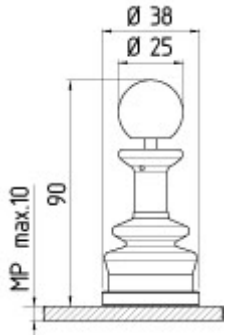

Dimensional drawing (miscellaneous)

K.A. Schmersal GmbH & Co. KG, Mödinghofe 30, D-42279 Wuppertal

The data and values have been checked thoroughly. Technical modifications and errors excepted.

Generiert am 13.02.2019 - 12:57:52h Kasbase 3.3.0.F.64I