

Datasheet - MKTC32



Command and signalling devices / Spring-return joystick switches WKT MKT, Maintained joystick switches WKS MKS, (C-18WKT C-47WKS) / Mounting hole \varnothing 22.3 mm / MKT - Spring-return joystick switches



- Mounting hole 22.3 mm
- Mounting Knurled nut
- bis 6 mm Front plate thickness
- without Locking sleeve
- 4 Contacts
- Mounting depth 70 mm
- 2 switch position

(Minor differences between the printed image and the original product may exist!)

Ordering details

| | |
|--------------------------|-------------|
| Product type description | MKTC32 |
| Article number | 101005832 |
| EAN Code | |
| eCl@ss | 27-37-14-04 |

Approval

Approval

Global Properties

| | |
|--------------------------------------|----------------------------------|
| Permanent light | MKT Kreuztaster |
| Standards | IEC/EN 60947-5-1, IEC/EN 60947-1 |
| Compliance with the Directives (Y/N) | Yes |
| Suitable for safety functions (Y/N) | No |
| suitable for exterior use (Y/N) | Yes |
| Climatic stress | IEC/EN 60068-2-20 |
| Mounting | Knurled nut |
| Mounting position | arbitrarily |
| Materials | |
| - Material of the front ring | Aluminium - anodized |

| | |
|---|--------|
| - Material of the bellows | Rubber |
| Material thickness of the sealing bellows | 1 |
| Color | |
| - Colour of the bellows | Black |
| - Colour of the front ring | Silver |
| Weight | 150 |
| Locking sleeve (Y/N) | No |

Mechanical data

| | |
|---------------------------------|---|
| Design of electrical connection | Screw connection |
| Cable section | |
| - Min. Cable section | 0,5 |
| - Max. Cable section | 2.5 |
| Mechanical life | 10.000.000 operations |
| Switching frequency | 1200 s |
| notice | All indications about the cable section are including the conductor ferrules. |
| Actuating force | 11 |
| restistance to shock | 110 / 4 - 30 / 18 |
| Resistance to vibration | > 20 / 10 ... 200 |
| Latching (Y/N) | No |
| Probing possible (Y/N) | Yes |
| Return to zero position (Y/N) | Yes |
| Latching position | left and right zero position |
| Number of switch positions | 2 |
| - Position A, B | |
| Number of directions | 2 |
| Front plate thickness | |
| - min. front plate thickness | 1.5 |
| - max. front plate thickness | 6 |

Ambient conditions

| | |
|----------------------------------|----------------------------|
| Ambient temperature | |
| - Min. environmental temperature | -25 |
| - Max. environmental temperature | +80 |
| Protection class | IP65, IP67 to IEC/EN 60529 |
| Degree of pollution | 3 IEC/EN 60947-1 |

Electrical data

| | |
|--|---|
| Design of control element | 2 Normally open contact (NO) / 2 Normally open contact (NO) |
| Switching principle | Creep circuit element |
| Number of auxiliary contacts | 4 |
| Number of safety contacts | 0 |
| Rated impulse withstand voltage | 4 |
| Rated insulation voltage | 400 |
| Thermal test current | 10 A |
| Utilisation category | AC-15: 250 V / 8 A DC-13: 24 V / 5 A |
| Max. fuse rating | 10 A gG D-fuse |
| - galvanically separated contact bridges | Yes |
| Contacts at position | |
| - A | 2 Normally open contact (NO) |

| | |
|----------------------------------|------------------------------|
| - B | 2 Normally open contact (NO) |
| - C | - |
| - D | - |
| Number of switching stages | 2 |
| Number of shutters per direction | 2 |

ATEX

| | |
|---|------|
| Explosion protection categories for gases | None |
| Explosion protected category for dusts | None |

Dimensions

| | |
|-------------------------------------|------------|
| Dimensions | |
| - Length of the actuator | 77 |
| - Mounting depth | 70 |
| Hole of central anchorage, diameter | 22.7 |
| Mounting hole IEC/EN 60947-1 | 22.3 + 0,4 |
| Spacing | 80 x 80 |

Documents

Datasheet (de) 937 kB, 15.11.2010

Code: k_krep02

Datasheet (en) 610 kB, 15.11.2010

Code: g_krep02

Mounting and wiring instructions (de, en) 223 kB, 06.09.2017

Code: m_mktp01_de-en

Declaration of conformity (de) 94 kB, 02.03.2017

Code: __krep01_de

Declaration of conformity (en) 91 kB, 06.03.2017

Code: __krep01_en

Brochure (de) 80 MB, 07.02.2012

Code: b_krep01_de

Brochure (de) 1 MB, 09.07.2012

Code: b_krep01_de

Brochure (en) 1 MB, 09.07.2012

Code: b_krep01_en

Brochure (pt) 1 MB, 09.07.2012

Code: b_krep01_pt

Brochure (es) 1 MB, 09.07.2012

Code: b_krep01_es

Images

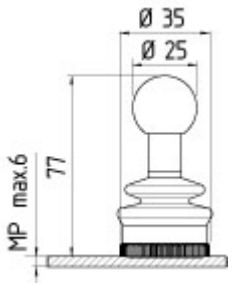

Dimensional drawing (miscellaneous)

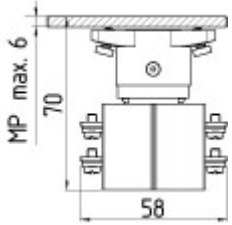

Dimensional drawing (miscellaneous)

K.A. Schmersal GmbH & Co. KG, Möddinghofe 30, D-42279 Wuppertal

The data and values have been checked thoroughly. Technical modifications and errors excepted.

Generiert am 13.02.2019 - 12:57:40h Kasbase 3.3.0.F.64I