

Floodlight

ZVZF001

Part Number



- Diffuse illumination with incident light mode
- Especially for through-beam operating mode
- Flashlight mode synchronizable with image processing

Technical Data

Optical Data	
Light Source	White Light
Service Life (T = +25 °C)	100000 h
Luminance (continuous light mode)	~ 13000 cd/m ²
Luminance (flashlight mode)	~ 35000 cd/m ²
Electrical Data	
Supply Voltage	22...27 V DC
Current Consumption (U _b = 24 V)	< 400 mA
Temperature Range	0...50 °C
Reverse Polarity Protection	yes
Protection Class	III
Mechanical Data	
Luminous Field Length (L)	80 mm
Housing Material	Aluminum
Degree of Protection	IP42
Connection	M12 × 1; 4-pin
Connection Diagram No.	749
Connection Table No.	32
Suitable Connection Technology No.	2

The wenglor floodlight can be used either with through-beam or incident light operating mode. Transparent and reflective objects as well as object contours are illuminated well.

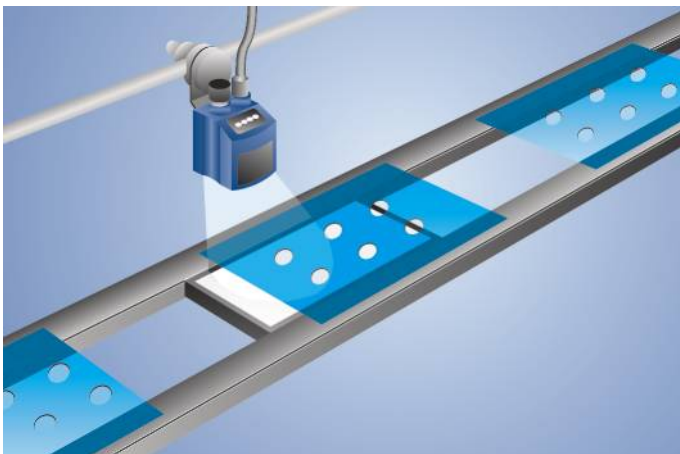

Complementary Products

Connection Cable BG2BSW1-08M, ZAV89V901, ZDCG001
Polarization Filter ZNNG008, ZVP0F0901

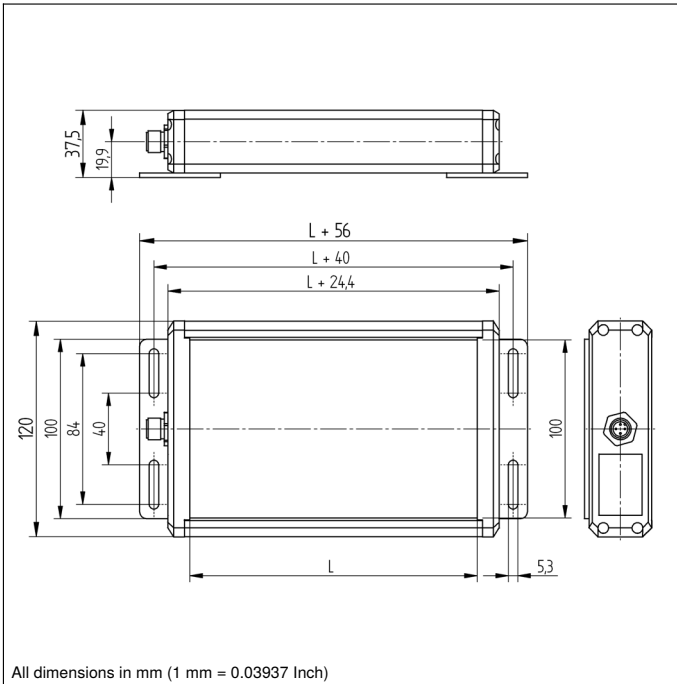

All dimensions in mm (1 mm = 0.03937 Inch)

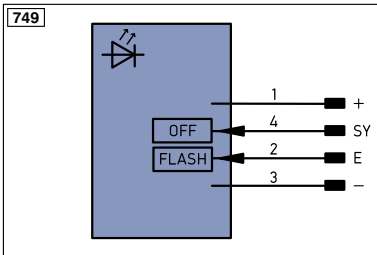

Legend

+	Supply Voltage +	nc	not connected	ENa	Encoder A
-	Supply Voltage 0 V	U	Test Input	ENb	Encoder B
~	Supply Voltage (AC Voltage)	U	Test Input inverted	AMIN	Digital output MIN
A	Switching Output (NO)	W	Trigger Input	AMAX	Digital output MAX
Ā	Switching Output (NC)	O	Analog Output	AOK	Digital output OK
V	Contamination/Error Output (NO)	O-	Ground for the Analog Output	SY In	Synchronization In
ṽ	Contamination/Error Output (NC)	BZ	Block Discharge	SY OUT	Synchronization OUT
E	Input (analog or digital)	Aw	Valve Output	Out	Brightness output
T	Teach Input	a	Valve Control Output +	M	Maintenance
Z	Time Delay (activation)	b	Valve Control Output 0 V		
S	Shielding	SY	Synchronization		
RxD	Interface Receive Path	E+	Receiver-Line		
TxD	Interface Send Path	S+	Emitter-Line		
RDY	Ready	≡	Grounding		
GND	Ground	SnR	Switching Distance Reduction		
CL	Clock	Rx+/-	Ethernet Receive Path		
E/A	Output/Input programmable	Tx+/-	Ethernet Send Path		
	IO-Link	Bus	Interfaces-Bus A(+)/B(-)		
PoE	Power over Ethernet	La	Emitted Light disengageable		
IN	Safety Input	Mag	Magnet activation		
OSSD	Safety Output	RES	Input confirmation		
Signal	Signal Output	EDM	Contactorm Monitoring		
Bl..D+/-	Ethernet Gigabit bidirect. data line (A-D)	ENaRS422	Encoder A/Ā (TTL)		
EN0 RS422	Encoder 0-pulse 0-0 (TTL)	ENbRS422	Encoder B/B̄ (TTL)		

Wire Colors according to DIN IEC 757

BK	Black
BN	Brown
RD	Red
OG	Orange
YE	Yellow
GN	Green
BU	Blue
VT	Violet
GY	Grey
WH	White
PK	Pink
GNYE	Green/Yellow

