

**ITEM 095558 CMS-R-AZA-10VL**

Description	Technical data	Accessories	Downloads
-------------	----------------	-------------	-----------

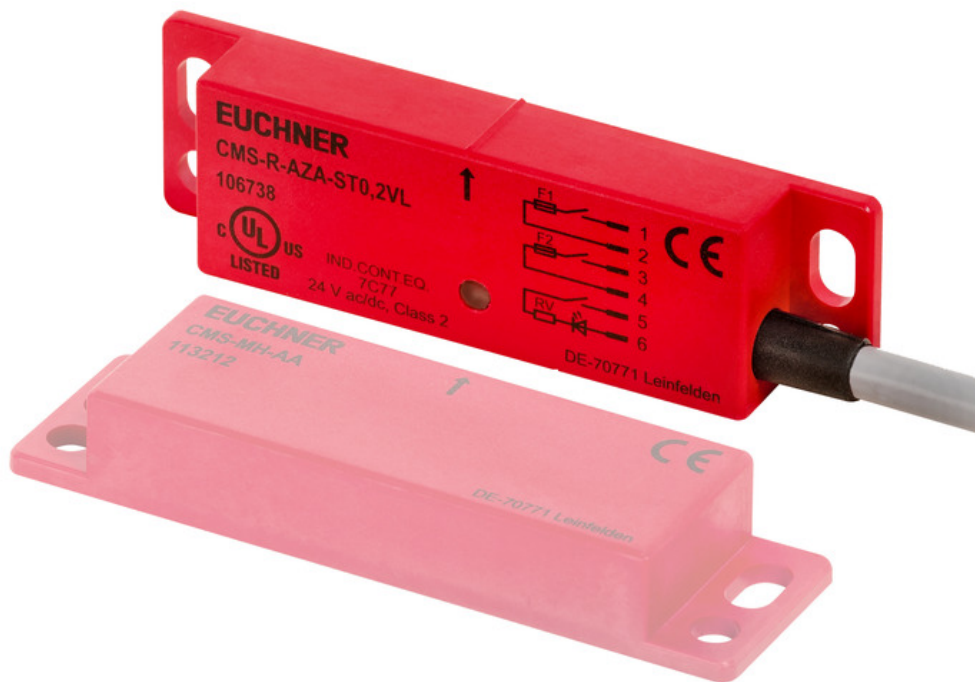

**Features**

- › In combination with evaluation units ESM-BA...
- › Cube-shaped version 88 x 25 mm
- › Connection cable
- › Cable type: PVC

**Alignment of read head and actuator**

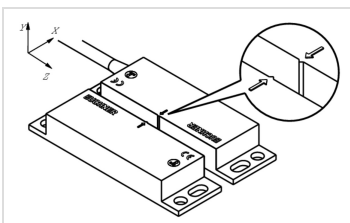

› Figure

**Operating diagram, design A**

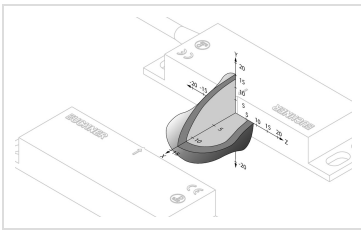

► CMS-R-AZA

Typ. switch-on distance

Typ. switch-off distance

## Approvals



## Mechanical values and environment

Design	A
Material	
Cable material	PVC
Housing material	Fiber glass reinforced PPS
Weight	
Net	0,5 kg
Ambient temperature	-20 ... 60 °C
Degree of protection	IP67
Mechanical life	100 x 10 <sup>6</sup>
Installation position	Any, pay attention to marking [1]
Tightening torque	0,4 ... 0,5 Nm
Number of NO contacts	2 NO contacts with fuse, 100 mA each and 1 NO contact with LED
Connection	Hard-wired encapsulated cable with cable end sleeves 0.25mm <sup>2</sup>
Cable length	10 m
Number of LED displays	1 LED contact status indication
Method of operation	Magnetic, reed contact

## Electrical connection ratings

Rated conditional short-circuit current	100 A [2]
Fusing	
Power supply / safety contacts, external contact protection	Fuse 10 A gG [3]
Switching voltage	
Contact status indication	24 ... 35 V
	24 ... 35 V
Switching current	
Contact status indication	max.20 mA

	max.100 mA
Switching characteristics	Parallel
Switching voltage according to UL	
According to UL Class 2	AC/DCmax.24 V
Series resistance	
LED contact status indication	1,5 kΩ
Switching frequency, electrical	
At I_min = 10 mA	max.5 Hz [4]
At nominal current 8 A	max.0,1 Hz [5]
Switching delay from state change	26 ms [6]

## Miscellaneous

in compliance with	EN ISO 13849-1: 2015; EN 62061: 2005 + AC: 2010 + A1: 2013 + A2: 2015; EN ISO 14119: 2013; IEC 60947-5-3: 2013
--------------------	--

## Reliability values acc. to EN ISO 13849-1

	Monitoring of the safety guard position
B10 <sub>D</sub>	20 x 10 <sup>6</sup>

**in combination with Evaluation unit ESM-BA201, ESM-BA202, ESM-BA203, ESM-BA301, ESM-BA302, ESM-BA303, ESM-BA201P, ESM-BA301P and Actuator CMS-M-AI**

## Operating distance

Center offset	
At s=3 mm read distance	2,5 mm [7]
Assured switch-off distance S <sub>ar</sub>	
Contact status indication/ LED	max.20 mm [8] max.15 mm [9]
Assured operating distance S <sub>a0</sub>	
With center offset m=0	min.9 mm [10]
Contact status indication/ LED	min.7 mm [11]

[1] During mounting it is to be ensured the marking arrows on actuator and read head are opposite each other.

[2, 3, 4, 5, 6] Parameter dependent on the evaluation units ESM-BA2.. and ESM-BA3..

[7, 10] Figure only applies if there is no ferromagnetic material in the vicinity of the read head and the actuator.

[8] The assured switch-off distance s<sub>ar</sub> corresponds to the reset distance.

[9, 11] These values apply only in approach direction X, center offset m=0.

**Dimension drawing**

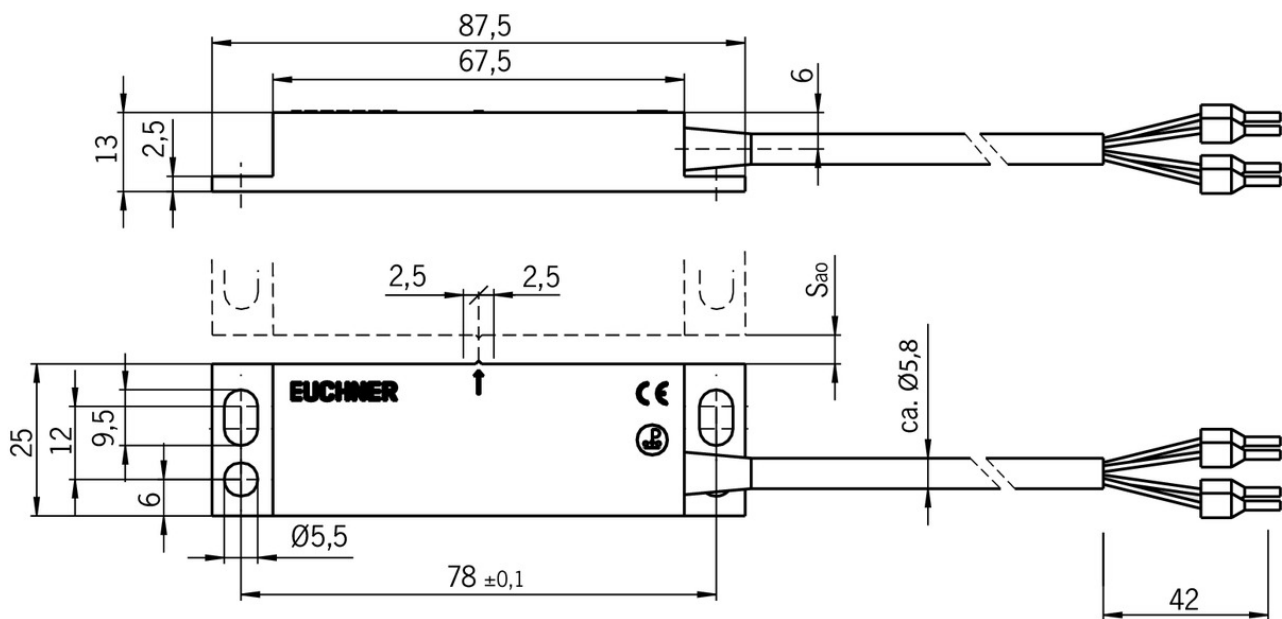

**CMS-R-AZA...**

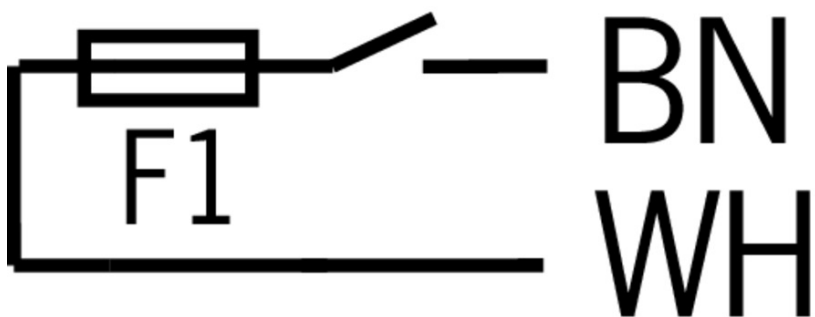

**WH**

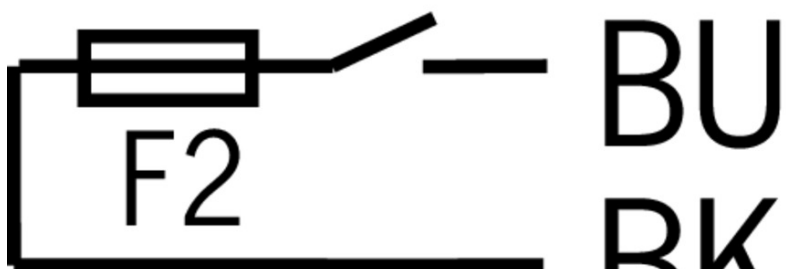

**BK**

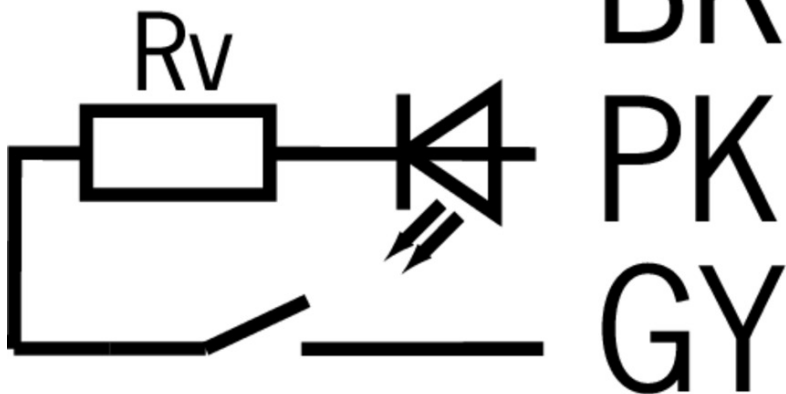

**GY**

## Actuator

### Actuator CMS design A









**093976** CMS-M-AI

#### Features

- › Cube-shaped version 88 x 25 mm

## Catalogs

### Magnetisch codierte Sicherheitsschalter CMS Système de sécurité sans contact CMS Magnetically Coded Safety Switches CMS

	Doc. no.	Version	Language	Download
Magnetisch codierte Sicherheitsschalter CMS	086823	09-02/18		 2.3 MB
Système de sécurité sans contact CMS	090606	09-02/18		 2.3 MB
Magnetically Coded Safety Switches CMS	086824	09-02/18		 2.3 MB

## CAD data

CAD data for this item on TraceParts