

## ITEM 083477 ZSE2-4C1943

Description	Technical data	Accessories	Downloads
-------------	----------------	-------------	-----------



### Features

- › 3-stage function
- › 30.5 mm installation dimension
- › Suitable, e.g. for installation in the hand-held pendant stations HBL, enabling switch housing G2 or G3 or control panel

### 3-stage function

Enabling function is active only in the second stage (middle position, actuating point). If the pushbutton is released or pushed further (panic function), the enabling is removed (dependent on the wiring, see function sequence).

### Switching element

220 2NO + 2NC ↻

### Approvals



## Mechanical values and environment

Material	Cap	Elastomer PAK arm, black
Housing material		Plastic, color black
Weight	Net	0,1 kg
Ambient temperature		-5 ... 60 °C
Degree of protection	On the front Connections	IP65 IP00
Mechanical life	Position 1-2-1 Position 1-2-3-1	cyclesmin.0,1 x 10 <sup>6</sup> cyclesmin.0,1 x 10 <sup>6</sup>
Switching principle		Slow-action contact element
Installation position		Any
Number of positively driven contacts		2
Number of NO contacts		2
Connection		Tab connector 2.8 x 0.8 IEC 760 + soldered connection

## Electrical connection ratings

Rated conditional short-circuit current		100 A
Utilization category according to EN 60947-5-1	AC-15 DC-13	4A 230V 3A 24V
Short circuit protection according to IEC 60269-1		4A gG
Rated insulation voltage U <sub>i</sub>		250 V
Rated impulse withstand voltage U <sub>imp</sub>		2,5 kV
Switching voltage	at 10mA	min.12 V
Switching current	at 24V	min.1 mA
Degree of contamination (external, according to EN 60947-1)	Industry	3

## Miscellaneous

C number	C1943	Euchner USA <sup>[1]</sup>
in compliance with		60947-5-8

**Reliability values acc. to EN ISO 13849-1**

	<b>Enabling switch</b>
B10 <sub>D</sub>	$0,5 \times 10^6$

[1] For installation in HBL, fastening hole  $\varnothing 30.5 +0.5$ , without pin for protection against twisting, total length shortened by 8mm

**Dimension drawing**

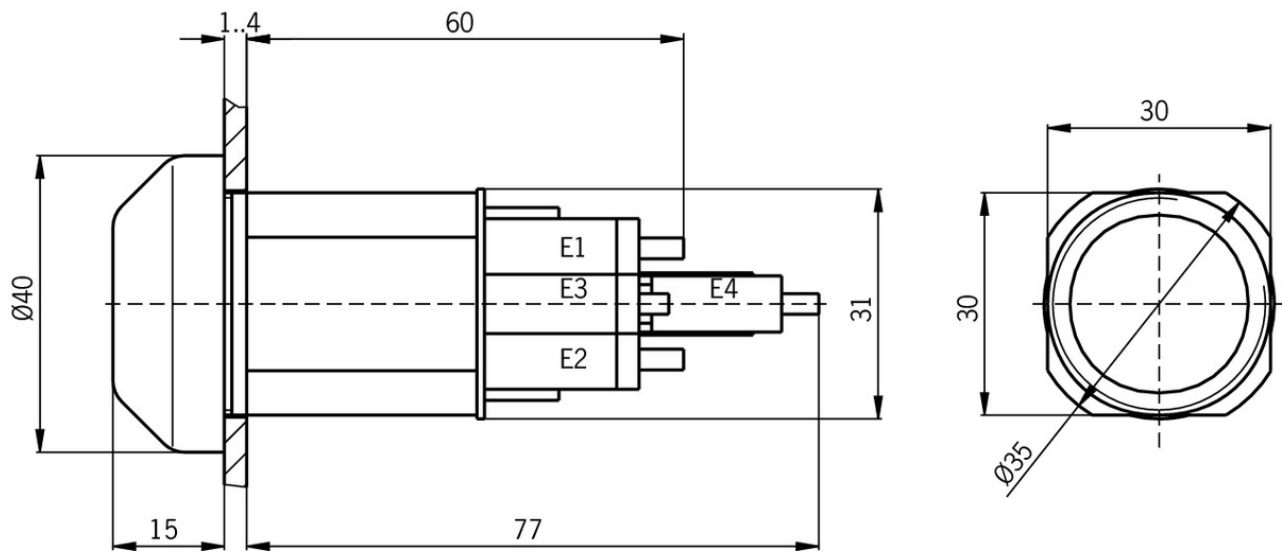

Dimension drawing

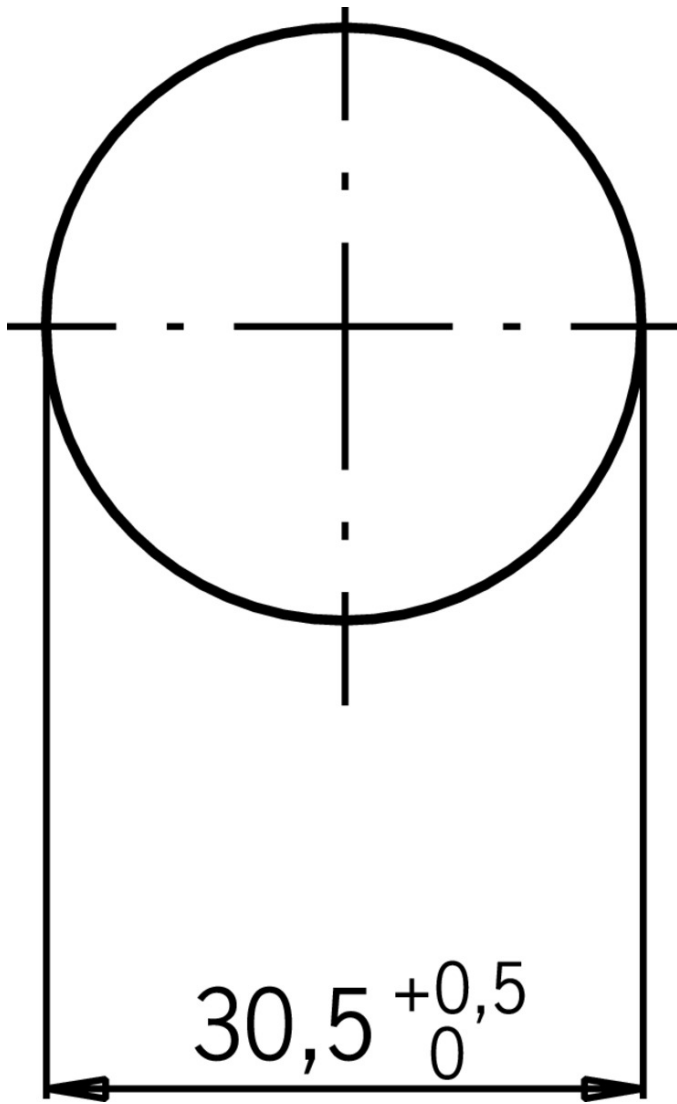

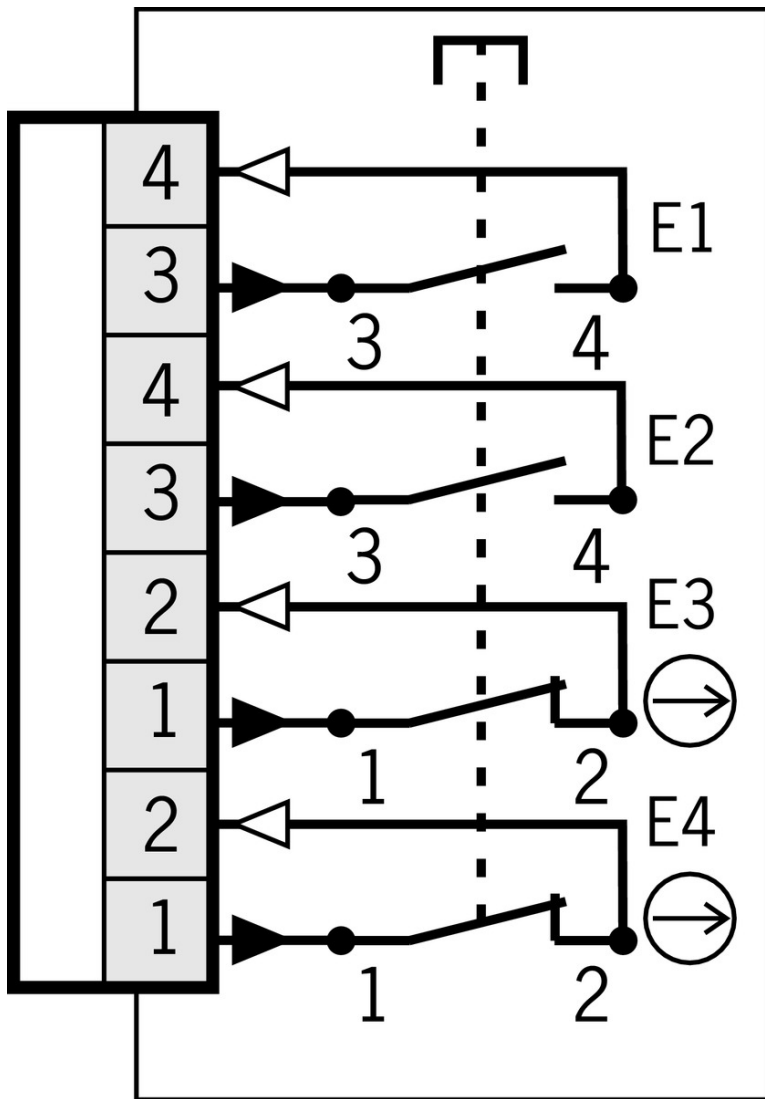

## Travel diagram

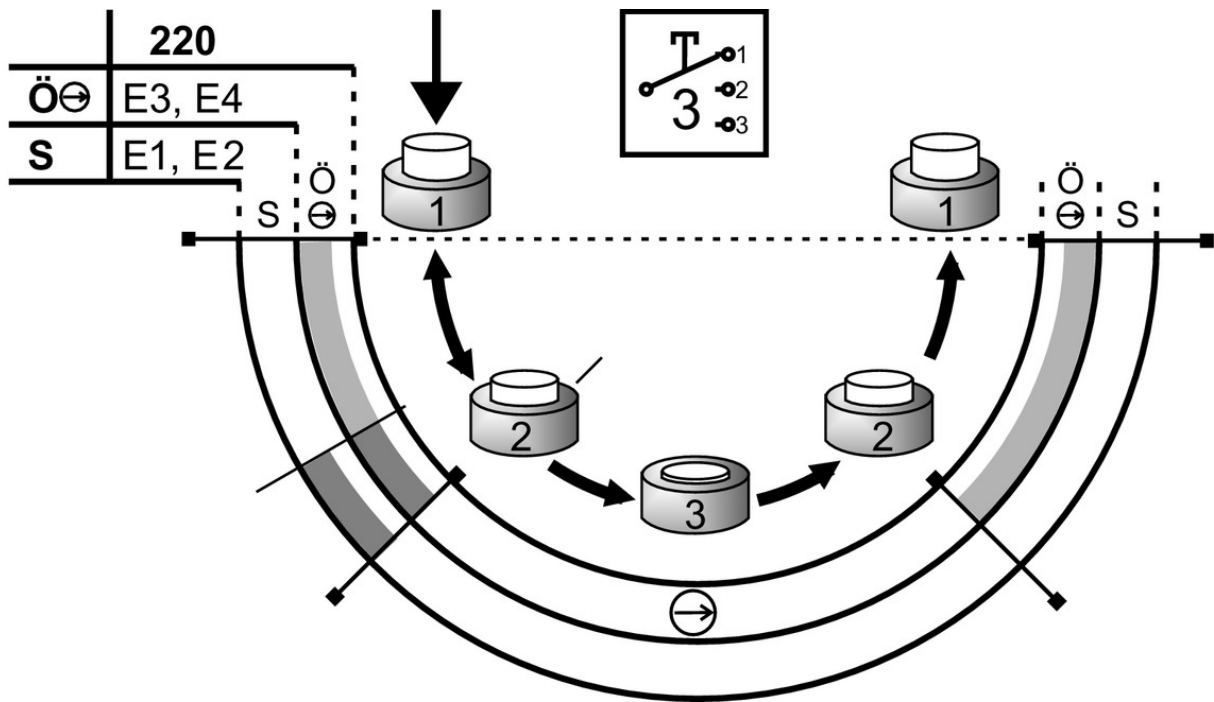

## Legende

- open
- closed
- closed, enabling

## Instructions







- Betriebsanleitung Zustimmtaster ZSE

	Doc. no.	Version	Language	Download
Betriebsanleitung Zustimmtaster ZSE	092780	03-12/13		0.4 MB
Manual de instrucciones del pulsador de validación ZSE				
Mode d'emploi de la commande d'assentiment ZSE				
Istruzioni di impiego del pulsante di consenso ZSE				
Manual de instruções da chave enable ZSE				
Operating Instructions Enabling Switch ZSE				
Návod k použití potvrdovacího tlačítka ZSE	092780	03-12/13		0.2 MB



## Catalogs

- Handbediengeräte/Handräder Hand-Held Pendant Stations/Handwheels Pupitres

portables/Manivelles







	<b>Doc. no.</b>	<b>Version</b>	<b>Language</b>	<b>Download</b>
Handbediengeräte/Handräder	098619	08-09/17		 3.0 MB
Pupitres portables/Manivelles	111529	08-09/17		 3.0 MB
Hand-Held Pendant Stations/Handwheels	099443	08-09/17		 3.0 MB

 Enabling switches ZS Commandes d'Assentiment ZS Zustimmungstaster ZS

	<b>Doc. no.</b>	<b>Version</b>	<b>Language</b>	<b>Download</b>
Zustimmungstaster ZS	095689	08-07/18		 9.1 MB
Commandes d'Assentiment ZS	097367	08-07/18		 4.9 MB
Enabling switches ZS	095690	08-07/18		 4.9 MB

## Declaration of conformity

 EU-Konformitätserklärung

	<b>Doc. no.</b>	<b>Version</b>	<b>Language</b>	<b>Download</b>
EU-Konformitätserklärung Declaración UE de conformidad Déclaration UE de conformité Dichiarazione di conformità EU declaration of conformity	2109392	04-11/16	    	 0.2 MB

## CAD data

CAD data for this item on TraceParts