

ITEM 083640 DRUCKTASTER SCHWARZ 1S

Description	Technical data	Accessories	Downloads
-------------	----------------	-------------	-----------

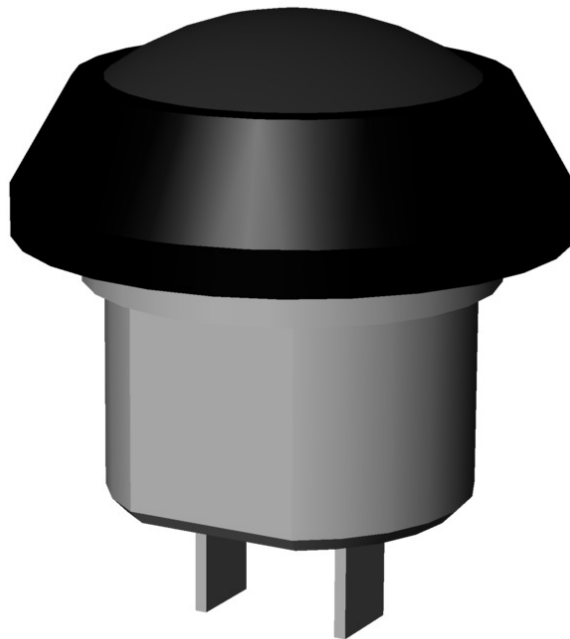

Components included in the set

Supplied accessories

Nut and seal included

Mechanical values and environment

Ambient temperature	max.+125 °C
Degree of protection	
On front (integrated in front panel)	IP67
Mechanical life	min.1 x 10 ⁶
Switching principle	Slow-action switching element
Number of switching elements	1 NO
Connection	Soldered connection
Type of actuation	Button
Electrical life	min.0,5 x 10 ⁶

Electrical connection ratings

Switching voltage	DC	50 V
Switching current		max.100 mA
Switching characteristics		Key function
Contact resistance		max.50 mΩ

Miscellaneous

Color	Black
-------	-------

Dimension drawing

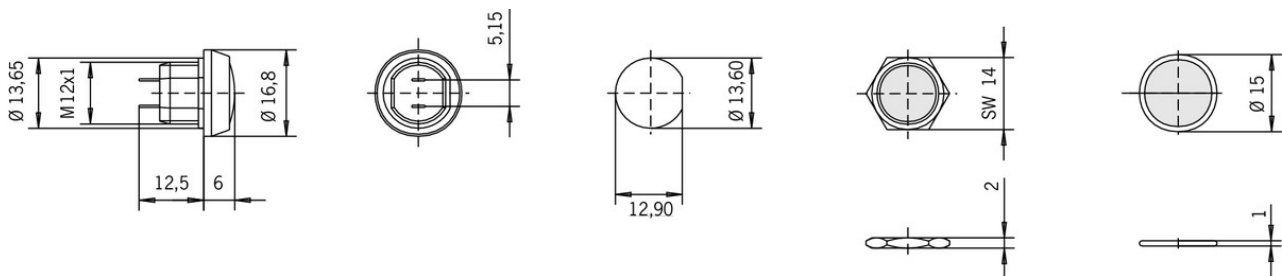

Catalogs

- Handbediengeräte/Handräder Hand-Held Pendant Stations/Handwheels Pupitres portables/Manivelles

	Doc. no.	Version	Language	Download
Handbediengeräte/Handräder	098619	08-09/17		3.0 MB
Pupitres portables/Manivelles	111529	08-09/17		3.0 MB
Hand-Held Pendant Stations/Handwheels	099443	08-09/17		3.0 MB

- Enabling switches ZS Commandes d'Assentiment ZS Zustimmungstaster ZS

	Doc. no.	Version	Language	Download
Zustimmungstaster ZS	095689	08-07/18		9.1 MB
Commandes d'Assentiment ZS	097367	08-07/18		4.9 MB
Enabling switches ZS	095690	08-07/18		4.9 MB

CAD data

CAD data for this item on TraceParts