

ITEM 074411 BETAETIGER-Z-G/V25

Description	Technical data	Accessories	Downloads
-------------	----------------	-------------	-----------

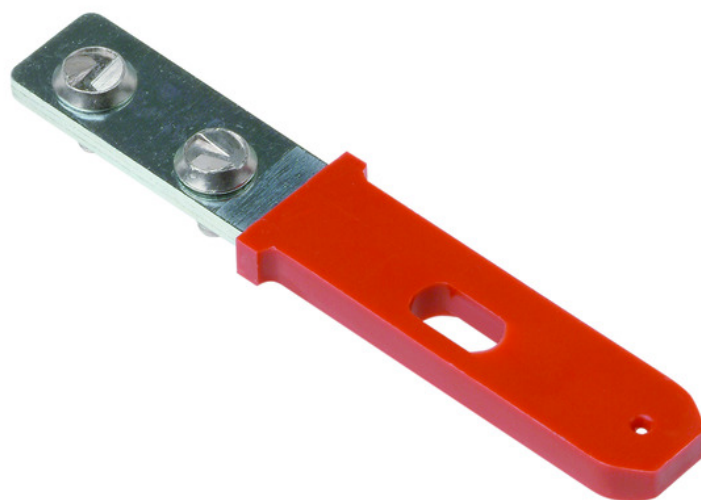

Features

- › Two stainless safety screws per actuator
- › Packaging unit 25 pieces

Straight actuator

The straight actuator is used on sliding doors or hinged doors with door radii greater than 1000 mm. Safety screws prevent unscrewing of the actuator. The safety screws included can be inserted with a normal tool, but cannot be removed again.

Actuator with overtravel

4 mm for doors with normal play

Mechanical values and environment

Material	Actuator	Galvanized steel
----------	----------	------------------

	screw	Stainless steel
	Sheath	Plastic
Door radius		min.1000 mm
Overtravel		max.4 mm

Miscellaneous

Usability of insertion funnel	No
Packaging unit	25 pcs.

Dimension drawing

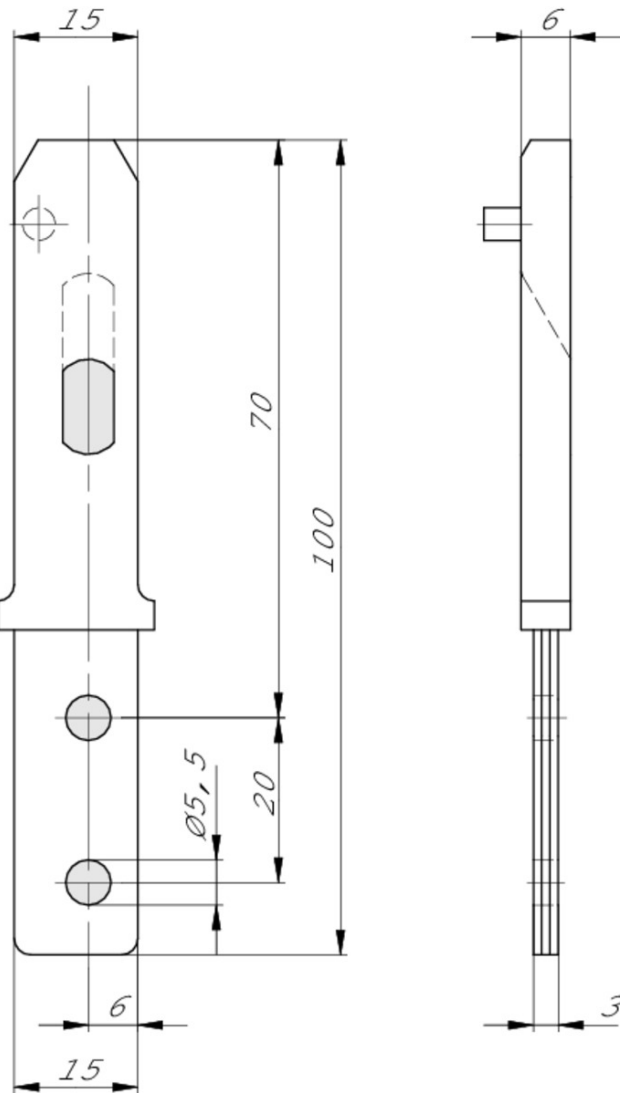

CAD data

CAD data for this item on TraceParts

