

## ITEM 111595 ZSM2304-111595

Description	Technical data	Accessories	Downloads
-------------	----------------	-------------	-----------



### Features

- › 3-stage function
- › Stop command device
- › LED indicator
- › + and - buttons
- › Selector switches
- › Coiled connection cable, 5 m
- › Plug connector

### 3-stage function

Enabling function is active only in the second stage (middle position, actuating point). If the pushbutton is released or pushed further (panic function), the enabling is removed (dependent on the wiring, see function sequence).

### Stop command device

Dual-channel emergency stop device (red, with pull-to-reset button) on the switch housing, for different wiring concepts.  
Lower position, protected by anti-kink cable gland in case of a fall.

## LED indicator

The LED indicator is used for visual feedback directly at the enabling switch.

---

## + and - buttons

These buttons can be configured individually. For example for moving axes in the positive or negative direction.

---

## Selector switches

As required, the adjustable detent positions can, e.g. be used for axis, speed or range selection.

---

## Cable

The high-quality connection cables are available in a coiled version.

## Approvals



## Mechanical values and environment

Material	PA, CR, TPE [1]
Weight	Net 2 kg
Ambient temperature	-5 ... 60 °C
Degree of protection	IP54
Mechanical life	1 x 10 <sup>6</sup>
Switching principle	Snap-action contact element
Number of changeover contacts	3 [2]
Connection	Plug connector number of pins 17
Cable length	coiled 5 m

## Electrical connection ratings

Rated conditional short-circuit current	100 A
Utilization category according to EN 60947-5-1	DC-13 24V 1A [3] 24V 0.3A [4] 24V 0.01A [5]
Short circuit protection according to IEC 60269-1	2A gG [6]

Rated insulation voltage U <sub>i</sub>	250 V
Rated impulse withstand voltage U <sub>imp</sub>	1,5 kV
Degree of contamination (external, according to EN 60947-1)	3
Connecting cable	23x0.14mm <sup>2</sup> [7]
Switching characteristics	3-stage enabling switch

### Miscellaneous

Additional feature	
Selector switch 3 positions	1 [8]
Pushbutton +	1 [9]
Pushbutton -	1 [10]
LED yellow	1 [11]
Emergency stop device	1 [12]
in compliance with	60947-5-8

### Reliability values acc. to EN ISO 13849-1

	<b>Enabling switch</b>
B10 <sub>D</sub>	0,1 × 10 <sup>6</sup>
	<b>Emergency stop</b>
B10 <sub>D</sub>	0,1 × 10 <sup>6</sup>

[1] PAK arm

[2, 8, 9, 10, 11, 12] Connection as per block diagram

[3] For enabling switch S4

[4] For additional devices

[5] For additional indicators

[6] In case of operating voltages other than 24 V, the short circuit protection must be dimensioned accordingly and checked.

[7] Screened

### Dimension drawing

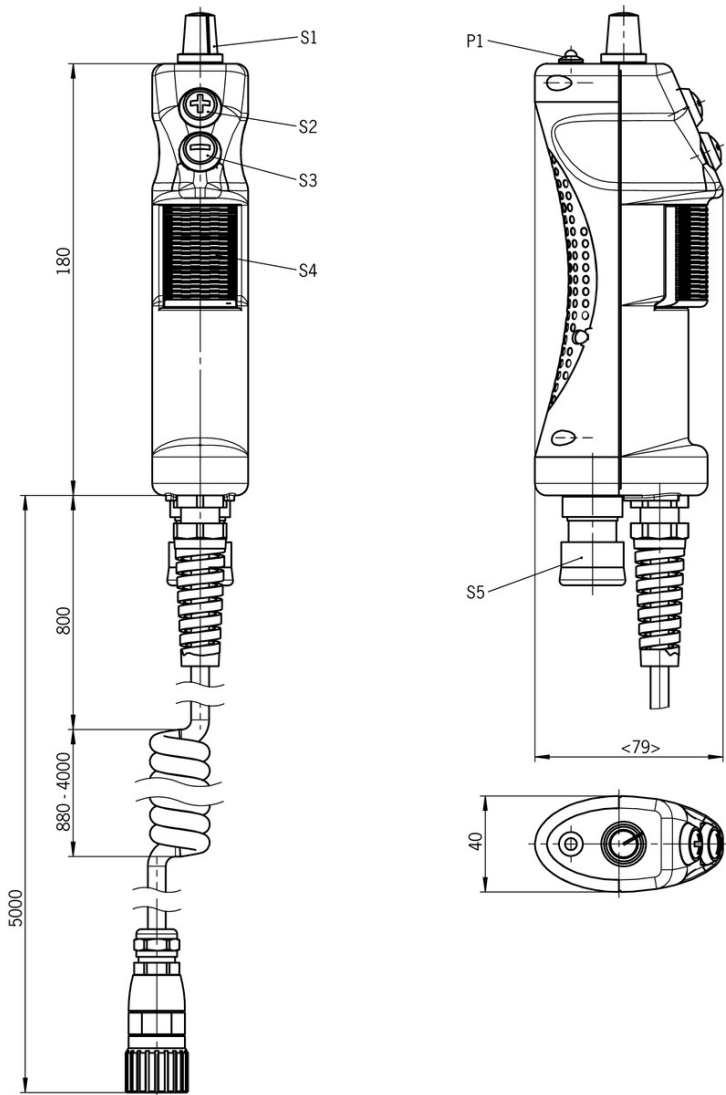

### Dimension drawing

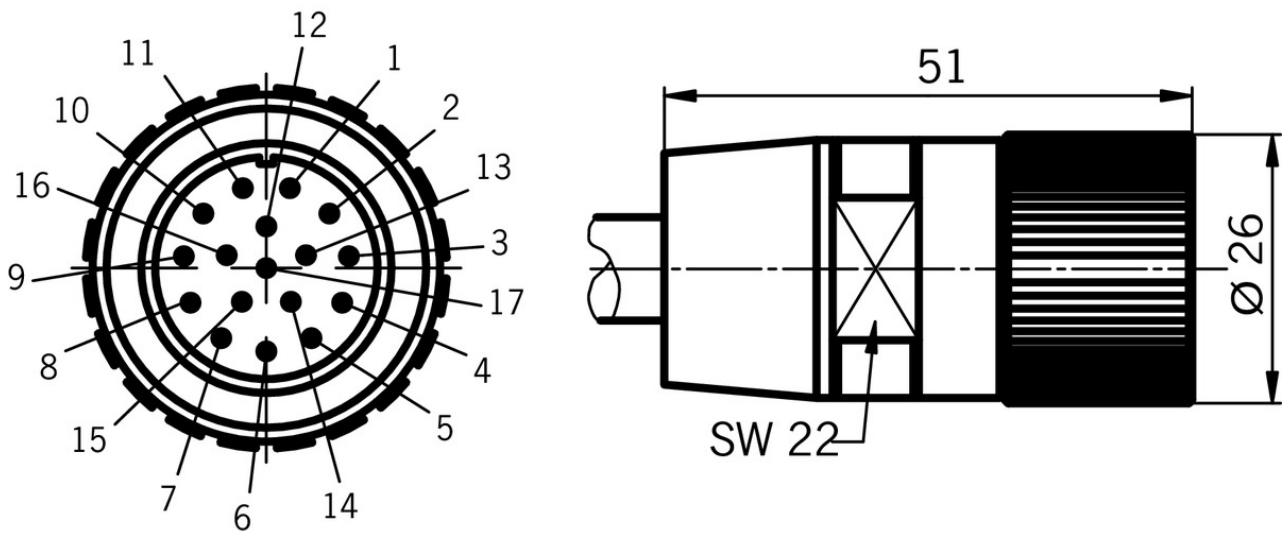

Switching element

E2



E3



Function sequence

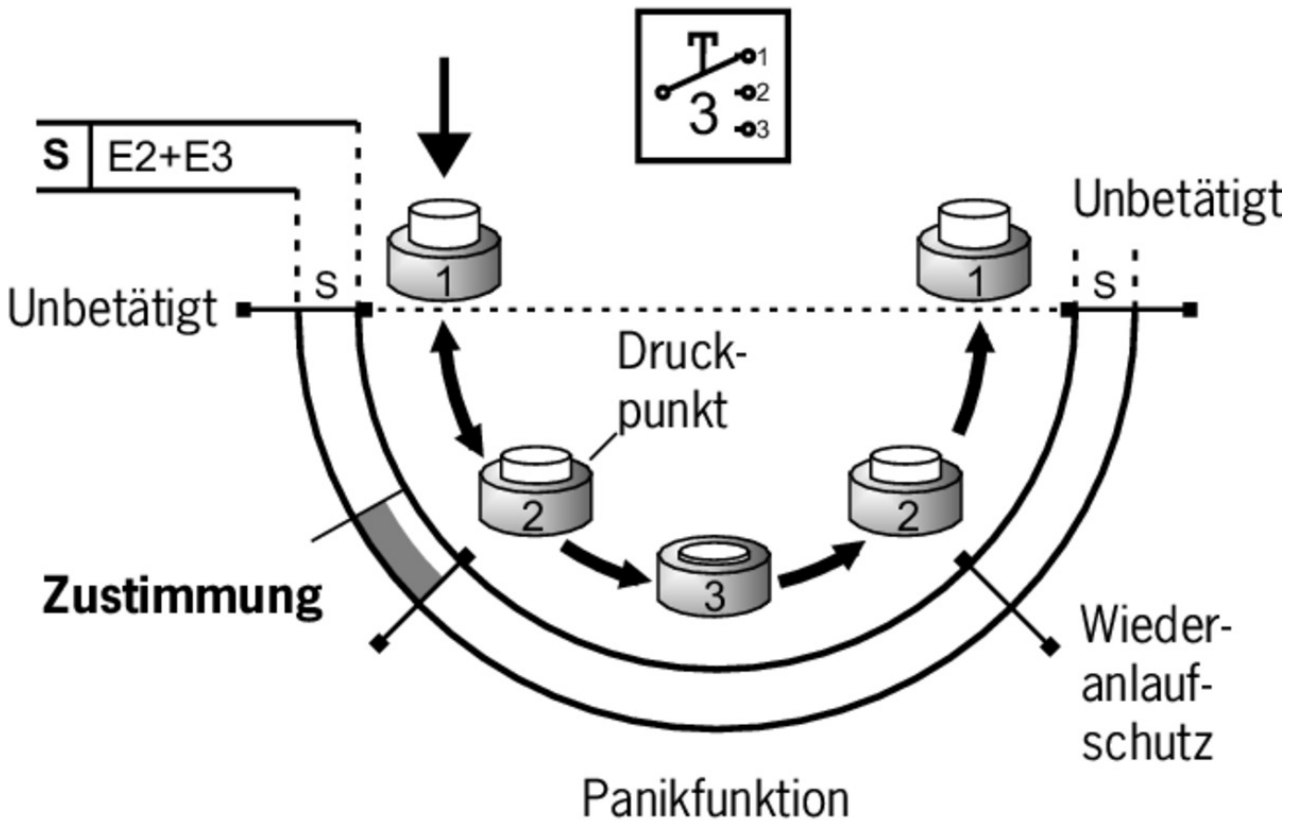

## Wiring diagram

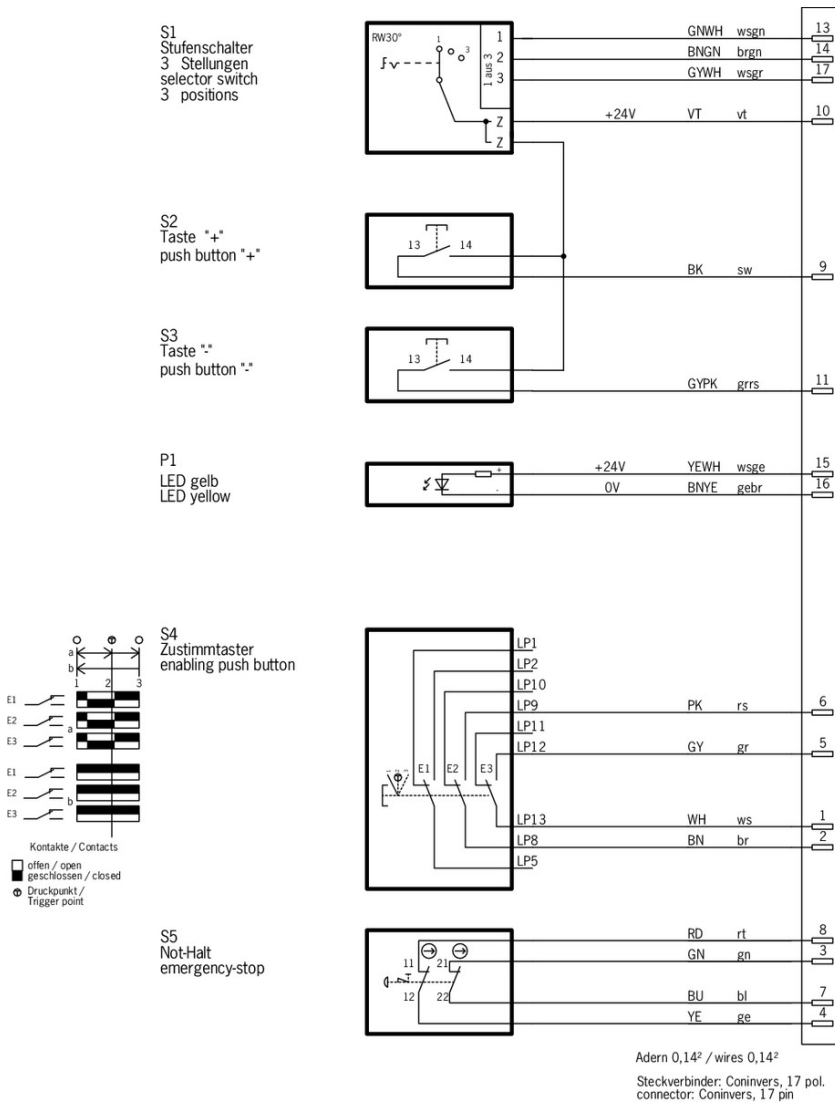

## Connection material

- Flange connector RC17 for front wall mounting for the connection of enabling switches



**077502** 17POL/CONINVERS N-COD

- Blanking plug RC17 for covering the flange connector RC17



**096159** BLINDSTECKER 17-POL RC-17P1N8A83NN

## Mounting accessories

- Holder for ZSM

**102969** HALTER ZSM



## Instructions

### ▼ Betriebsanleitung Zustimmtaster ZSM

	Doc. no.	Version	Language	Download
Betriebsanleitung Zustimmtaster ZSM Manual de instrucciones del pulsador de validación ZSM Mode d'emploi de la commande d'assentiment ZSM Operating Instructions Enabling Switch ZSM	098540	05-08/11	   	0.7 MB
Návod k použití potvrzovacího tlačítka ZSM	098540	05-08/11		0.3 MB
Istruzioni di impiego del pulsante di consenso ZSM	098540	05-08/11		0.2 MB
Manual de instruções da chave enable ZSM	098540	05-08/11		0.2 MB
Instrucțiuni de utilizare pentru butonul de activare ZSM	098540	05-08/11		0.3 MB

## Declaration of conformity

### ▼ EU-Konformitätserklärung

	Doc. no.	Version	Language	Download
EU-Konformitätserklärung Declaración UE de conformidad Déclaration UE de conformité Dichiarazione di conformità EU declaration of conformity	2109392	04-11/16	    	0.2 MB