

**ITEM 072940 HKC025S100G12**

| Description | Technical data | Accessories | Downloads |
|-------------|----------------|-------------|-----------|
|-------------|----------------|-------------|-----------|



**Features**

- › 100 detent positions per revolution
- › Wear-free magnetic detent mechanism
- › 25 pulses per revolution
- › Flat design

**Approvals**



**Mechanical values and environment**

|                     |               |
|---------------------|---------------|
| Material            | Aluminum      |
| Weight              | Net 0.095 [1] |
| Ambient temperature | 0 ... 50 °C   |

|   |                                      |
|---|--------------------------------------|
| Atmospheric humidity<br>(condensation not permissible)          | 0.8                                  |
| Degree of protection<br>IEC 529<br>acc. to NEMA 250             | IP65 <b>[2]</b><br>250-12 <b>[3]</b> |
| Resilience to vibration<br>Vibration (3 axes)<br>Shock (3 axes) | DIN/IEC 68-2-6<br>DIN/IEC 68-2-27    |
| Tightening torque   | max.0,25 Nm                          |
| Connection  | Screw terminal 7-pole                |
| Detent positions per revolution                                 | 100                                  |

### Electrical connection ratings

|   |  |
|---|--|
| Operating voltage DC                                      | 10 ... 30 V DC   |
| Current consumption<br>Without load                       | max.80 mA  |
| EMC protection requirements<br>Acc. to CE                 | EN 61000-6-2, EN 61000-6-4   |
| Type of output  | Push-pull  |
| Connection cross-section                                  | 0,08 ... 1,5 mm <sup>2</sup>   |
| Connection cross-section, AWG                             | 28 ... 16 AWG  |
| Pulses per revolution                                     | 2x25   |
| Output voltage<br>High(1)<br>High(1)<br>High(1)<br>Low(0) | at 0 mAmin.4,9 V DC<br>at 5 mAmin.3,9 V DC<br>at 20 mAmin.3,6 V DC<br>at 15 mAmax.1,3 V DC |

### Miscellaneous

|                  |          |
|------------------|----------|
| Detent mechanism | Magnetic |
|------------------|----------|

**[1]** Without dial

**[2, 3]** On the front

**Dimension drawing**

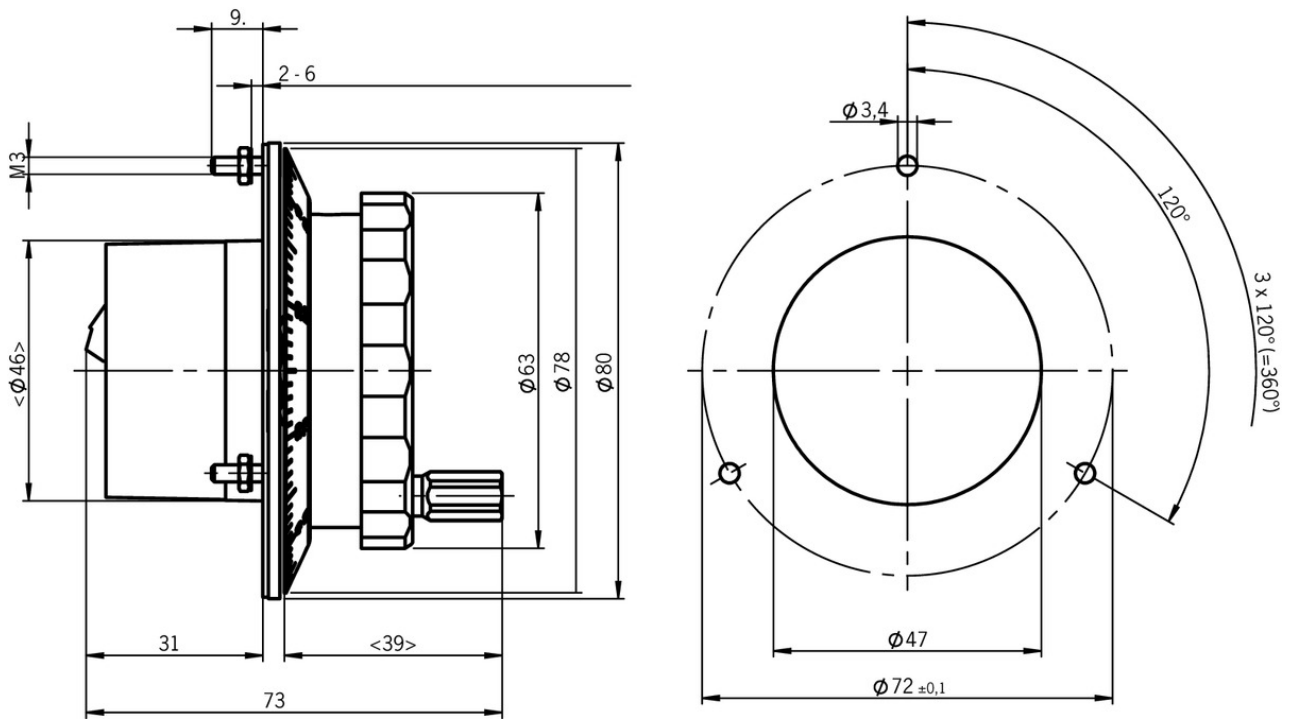

**Dimension drawing**

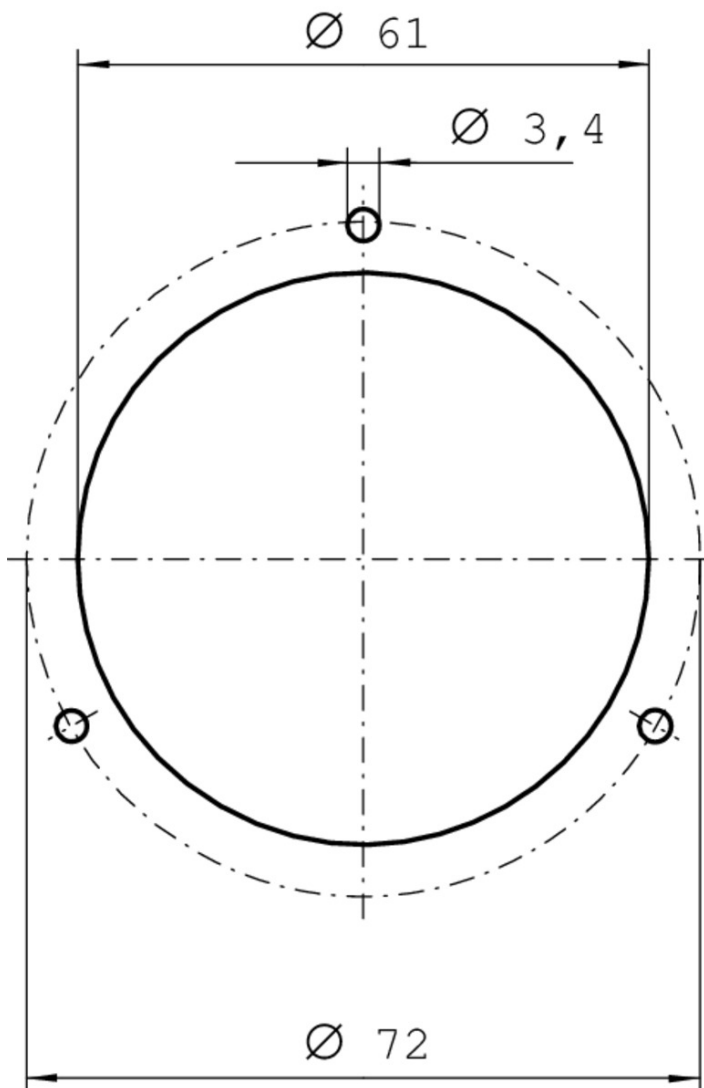

## Terminal assignment

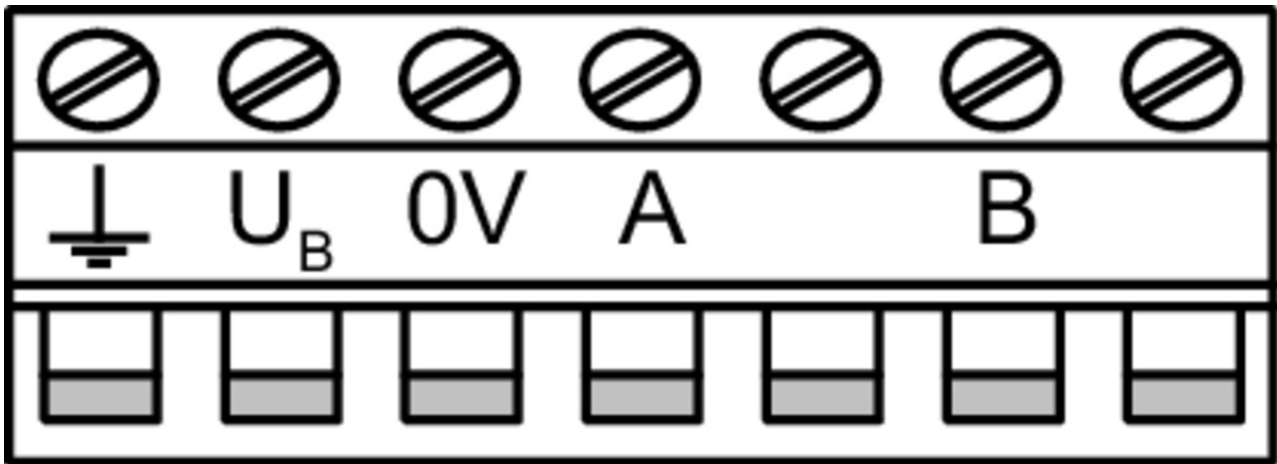



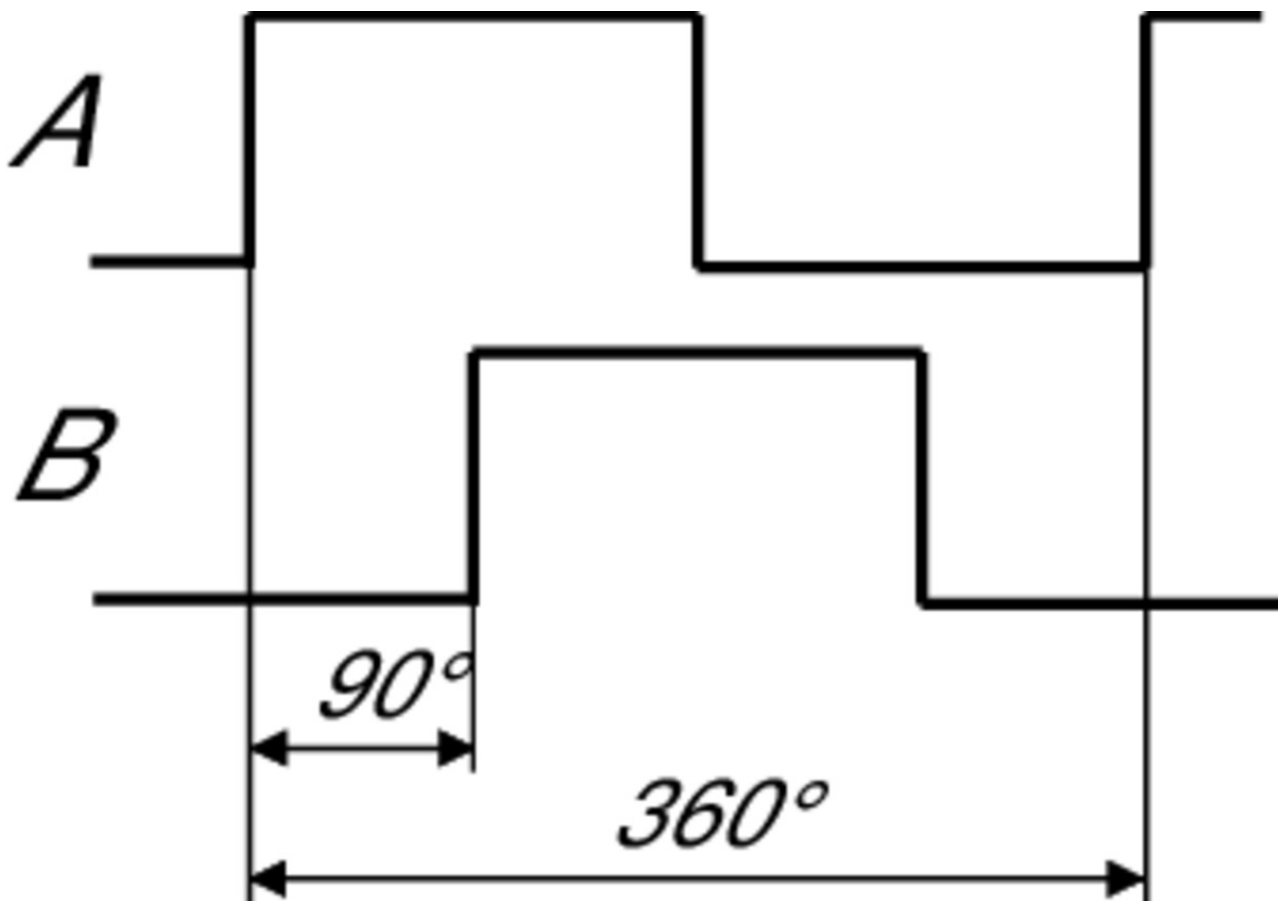

## Ausgangssignale



## Instructions







Betriebsanleitung Elektronisches Handrad HKC

Doc. no.   Version   Language   Download

|   |        |          |   |   |
|---|--------|----------|---|---|
| Betriebsanleitung Elektronisches Handrad HKC    | 104604 | 03-07/15 |   |  1.1 MB |
| Mode d'emploi Manivelle électronique HKC        |        |          |  |   |
| Istruzioni di impiego Volantino elettronico HKC |        |          |  |   |
| Operating instructions Electronic handwheel HKC |        |          |  |   |

## Catalogs

### Handbediengeräte/Handräder Hand-Held Pendant Stations/Handwheels Pupitres portables/Manivelles

|                                       | Doc. no. | Version  | Language  | Download   |
|---------------------------------------|----------|----------|---|--|
| Handbediengeräte/Handräder            | 098619   | 08-09/17 |  |  3.0 MB |
| Pupitres portables/Manivelles         | 111529   | 08-09/17 |  |  3.0 MB |
| Hand-Held Pendant Stations/Handwheels | 099443   | 08-09/17 |  |  3.0 MB |

## CAD data

CAD data for this item on TraceParts