

ITEM 072972 HWA025T100G12/V10

Description	Technical data	Accessories	Downloads
-------------	----------------	-------------	-----------



Features

- › 100 detent positions per revolution
- › Mechanical detent mechanism
- › 25 pulses per revolution
- › Center point fixing

Notes

- › Packaging unit 10 pieces

Approvals



Mechanical values and environment

Material	Plastic
----------	---------

Weight	Net	0.1
Ambient temperature		0 ... 50 °C
Atmospheric humidity (condensation not permissible)		0.8
Degree of protection	IEC 529 acc. to NEMA 250	IP65 [1] 250-12 [2]
Mechanical life		1 x 10 ⁶
Connection		Screw terminals 4-pole
Detent positions per revolution		100

Electrical connection ratings

Operating voltage DC		12 V DC -10% ... 10%
Current consumption	Without load	max.80 mA
Type of output		Push-pull
Pulses per revolution		2x25
Output voltage	High(1) Low(0)	at 20 mAmin.4,0 V DC at 20 mAmax.0,5 V DC

Miscellaneous

Additional feature	Front panel thickness	1.5 - 2.0mm
Detent mechanism		Mechanical
Packaging unit		10

[1, 2] On the front

Dimension drawing

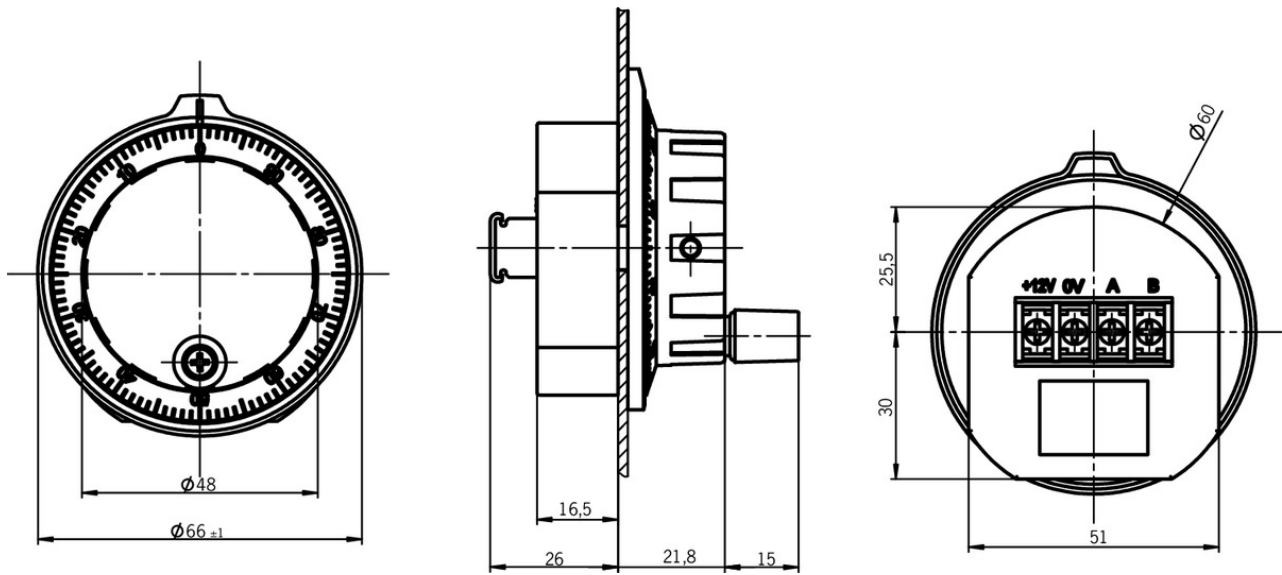

Dimension drawing

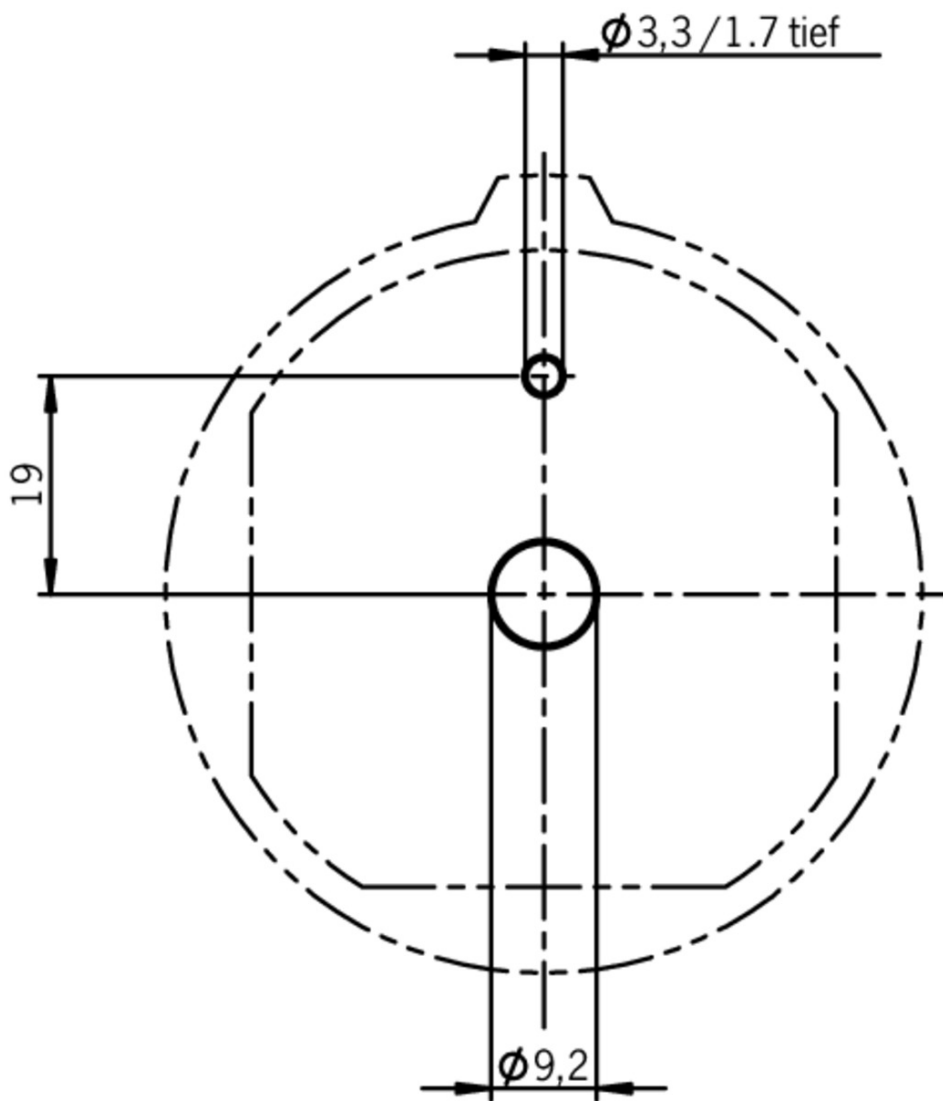

Terminal assignment

$+U_B$ $0V$ A B

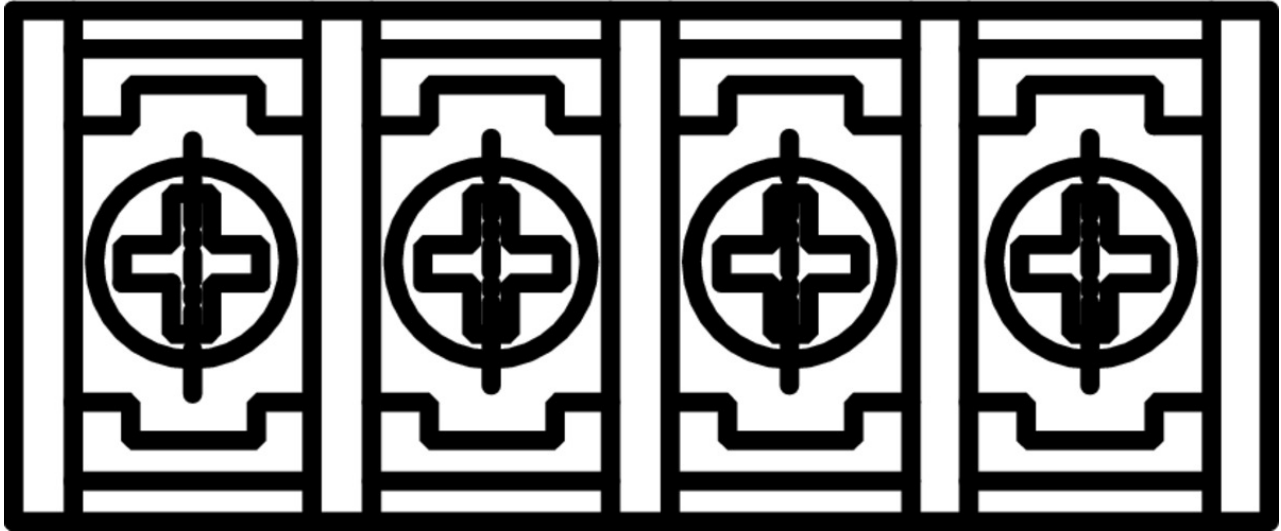



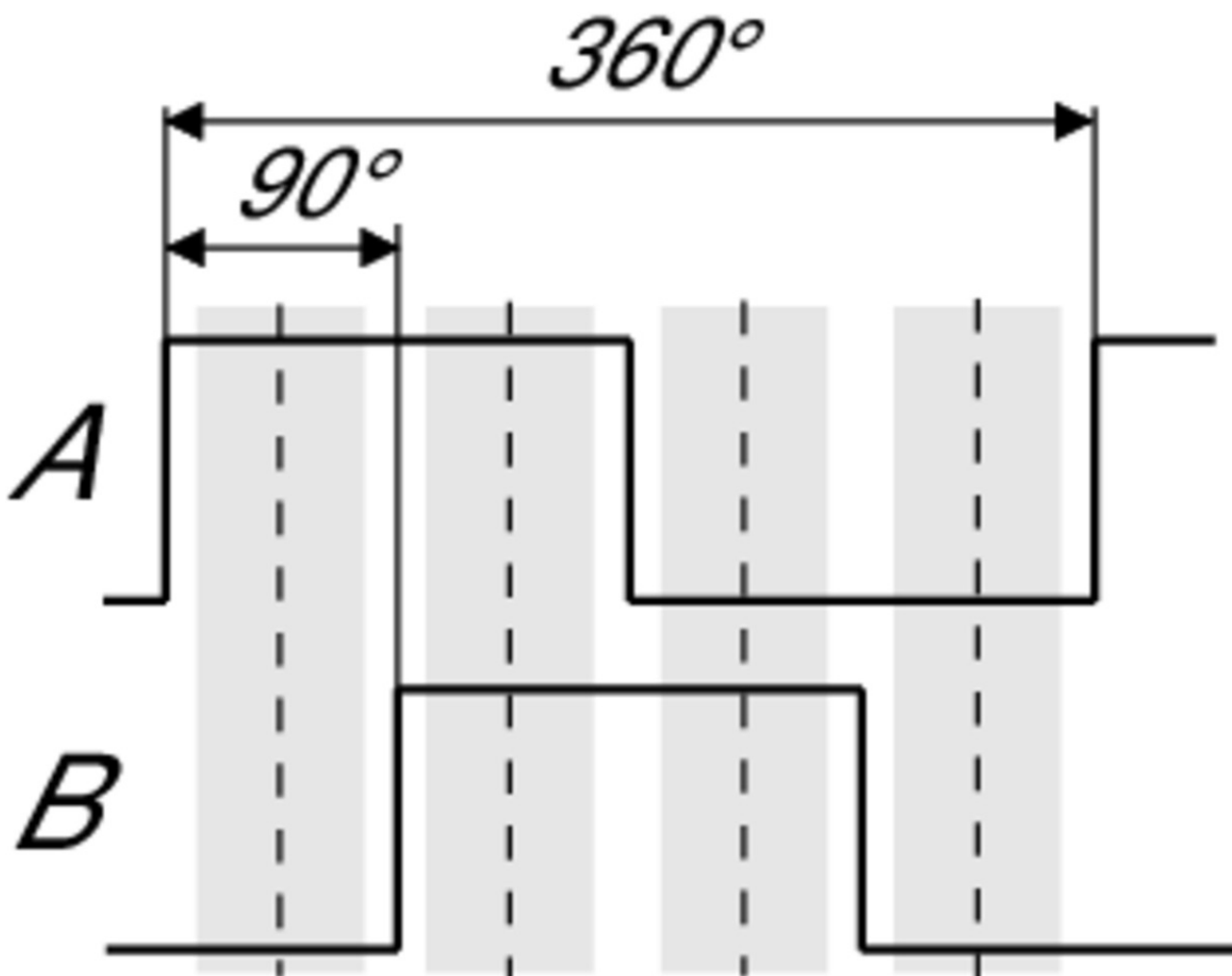

Ausgangssignale









Instructions

▼ Betriebsanleitung Elektronisches Handrad HWA/HWB

	Doc. no.	Version	Language	Download
Betriebsanleitung Elektronisches Handrad HWA/HWB	072993	02-08/06		 1.2 MB
Mode d'emploi de la manivelle électronique HWA/HWB				
Istruzioni di impiego volante elettronico HWA/HWB				
Operating instructions for electronic handwheel HWA/HWB				

Catalogs

▼ Handbediengeräte/Handräder Hand-Held Pendant Stations/Handwheels Pupitres portables/Manivelles

	Doc. no.	Version	Language	Download
Handbediengeräte/Handräder	098619	08-09/17		 3.0 MB
Pupitres portables/Manivelles	111529	08-09/17		 3.0 MB
Hand-Held Pendant Stations/Handwheels	099443	08-09/17		 3.0 MB

CAD data

CAD data for this item on TraceParts