

**AO000479**

**ACCESSORIES • LENSES**

A lens is a gathering, optical system that generates a real optical image of an object. The correct choice of a suitable lens, which is ideal for the respective application in combination with the camera sensor, plays an important role. The figure of the image circle or image field is projected through the lens to the image sensor that converts it into electrical signals.



**MECHANICAL DATA**

Housing material	Aluminium
Image circle diameter	11 mm
Material of optical surface	Glass
Sensor diameter	61 mm
Sensor length	164.9 mm
Thread pitch	0.79 mm
Thread size, metric	25.4
With C-mount thread	Yes

**OPTICAL DATA**

Aperture number	8
Depth of focus	11 mm
Lens type	Telecentric
Magnification	0.24
Motor zoom	No
Operating distance	102.5 mm
Resolution capacity	Up to 2 megapixel
Telecentricity	0.08 °

**OTHER DATA**

Distortion	0.1 %
------------	-------

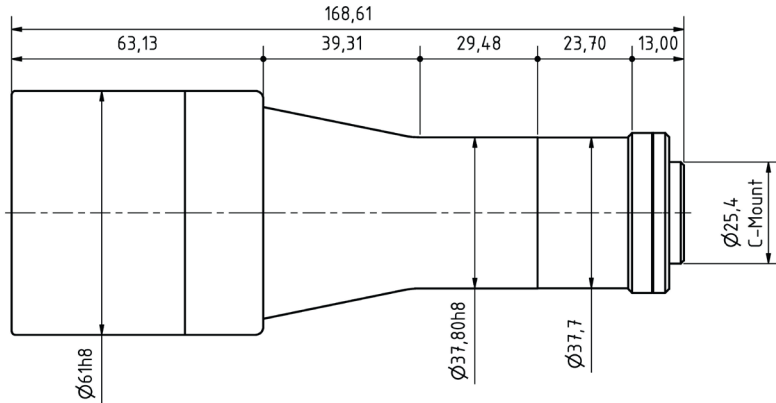
**DIMENSIONAL DRAWING****INSTALLATION**

Mounting / Installation may only be carried out by a qualified electrician!

**DISPOSAL****SAFETY WARNINGS**

Before initial operation, please make sure to follow all safety instructions that may be provided in the product information!