

## CM030980

### COUNTERS • MULTI-FUNCTION COUNTERS



#### MECHANICAL DATA

Ambient temperature	-20 °C ... 65 °C
Degree of protection (IP)	IP65
Height	48 mm
Housing material	Polycarbonate
Length	106.6 mm
Mounting method	Front mounting
Storage temperature	75 °C
Storage temperature	-25 °C
Width	48 mm

#### ELECTRICAL DATA

Adding	Yes
Counting frequency	55 kHz
Display	LCD
Max. output current 1	3 A
Max. output current 2	3 A
Number of decades	12
Number of pins	13
Number of presets to be set	2
Number of switching outputs	2
Operating voltage	10 V ... 30 V
Power consumption	4.5 W
Primary voltage	24 V
Pulse counter	Yes
Rated control supply voltage $U_s$ at DC	10 V ... 30 V
Subtracting	Yes
Switching capacity	30 VA
Switching current	3 A
Switching voltage	250 V
Timed output	99.99 s
Transducer power supply current	80 mA

**ELECTRICAL DATA**

Transducer power supply voltage	24 V
Type of 2nd switching function	Change-over contact (NO/NC)
Type of 2nd switching output	Relay contact
Type of electrical connection	Screw connection
Type of signal input A	PNP/NPN
Type of signal input B	PNP/NPN
Type of switching function	Change-over contact (NO/NC)
Type of switching output	Relay contact
Voltage type	DC
With elapsed-time counting function	Yes
With quadruple evaluation	Yes
With reset function	Yes

**OPTICAL DATA**

Background lighting of LC display	Yes
-----------------------------------	-----

**OTHER DATA**

Number of characters	12
----------------------	----

**DIMENSIONAL DRAWING**

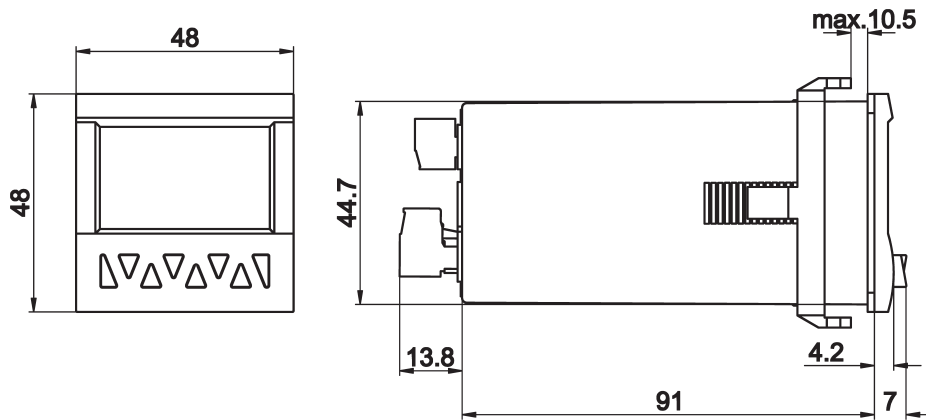

**INSTALLATION**



Mounting / Installation may only be carried out by a qualified electrician!

**DISPOSAL**



**SAFETY WARNINGS**

Before initial operation, please make sure to follow all safety instructions that may be provided in the product information!

