

ES350120

LED-LIGHTS • ADDITIONAL LIGHTS FOR CAMERA SYSTEMS

For any kind of inspection tasks with a camera sensor the lighting is essential, as only high-contrast images enable reproducible evaluations. Here the lighting has a decisive influence. The choice depends on different factors such as the distance to the test object, its size, the component criteria to be tested or the expected environmental conditions.



MECHANICAL DATA

Ambient temperature	5 °C ... 45 °C
Degree of protection (IP)	IP67
Diameter	35 mm
Front screen material	Acrylic glass
Housing design	Round
Housing material	Aluminium
Length	74 mm
Light head material	Plastic
Type of lamp stand	Screw-on plate
Wet area	Yes

ELECTRICAL DATA

Lamp power	3 W
Max. current consumption	15 mA
Nominal supply voltage	10 V ... 30 V
Number of pins	4
Protection class	III
Type of electrical connection	Connector M12
Voltage type	DC

OPTICAL DATA

Actual camera illumination	Yes
Lamp	LED
Light source	White light
Light version	Spotlight
Number of LEDs	1
Radiation angle	26 °
With lamp	Yes

OTHER DATA

Harsh environmental conditions	Yes
--------------------------------	-----

CONNECTION

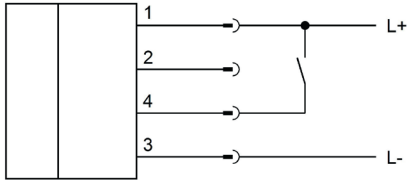

DIMENSIONAL DRAWING

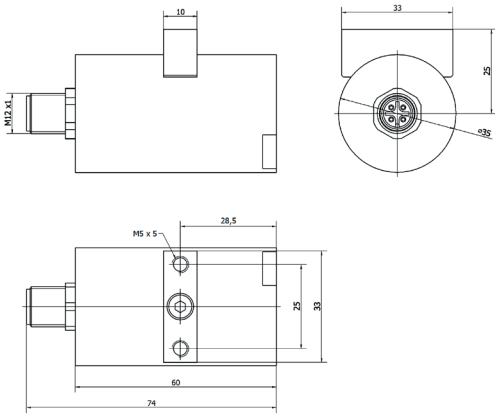

INSTALLATION



Mounting / Installation may only be carried out by a qualified electrician!

DISPOSAL



SAFETY WARNINGS

Before initial operation, please make sure to follow all safety instructions that may be provided in the product information!