

**NY98E186**

•

Pulsed power supplies are used to supply electrical systems or system parts with a stabilized DC voltage. Due to the lower copper losses, pulsed power supplies in the lower power range are considerably more efficient than power transformers. Furthermore, they are more compact and are lighter weight than conventional, linear regulated power supplies, which contain a heavy transformer with iron core and cause additional losses in the linear regulator.

**MECHANICAL DATA**

Ambient temperature	-20 °C ... 50 °C
Degree of protection (IP)	IP20
Direct mounting possible	No
Housing material	Plastic
Rail mounting possible	Yes
Suitable for serial installation	No
Wall mounting possible	No

**ELECTRICAL DATA**

1. output voltage	2 V ... 55 V
Frequency	50 Hz ... 60 Hz
Max. output current 1	0.8 A
Output voltage, regulated	No
Power output	32 W
Rated supply voltage at AC 50 Hz	220 V ... 240 V
Secondary voltage, adjustable	No
Suitable for safety functions	No
Type of electrical connection	Screw connection
Voltage type of supply voltage	AC

**OTHER DATA**

Stabilized	Yes
------------	-----

## CONNECTION

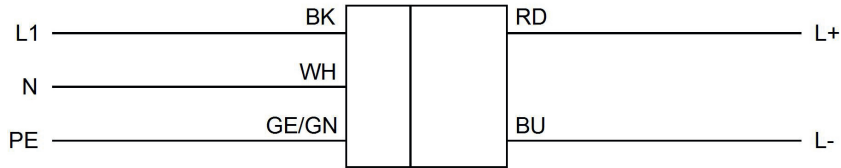

**Colors:** BN (brown), WH (white), GR/YE (green/yellow)  
**RD** (red), **BU** (blue)  
**Functions:** BN = L+, WH = L-, GR/YE = PE  
 RD = L+, BU = L-

## DIMENSIONAL DRAWING

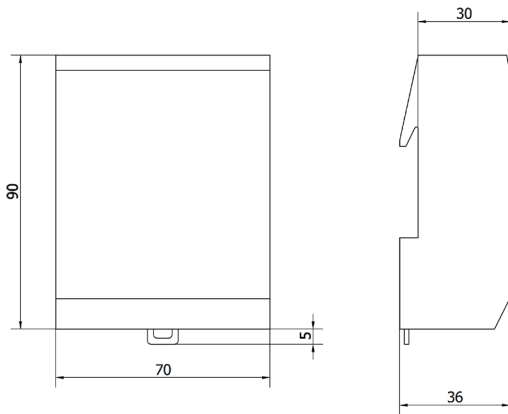

## INSTALLATION



Mounting / Installation may only be carried out by a qualified electrician!

## DISPOSAL



## SAFETY WARNINGS

Before initial operation, please make sure to follow all safety instructions that may be provided in the product information!