

PESI0311

LASER SENSORS • THROUGH-BEAM SENSORS RECEIVERS

Optical sensors function contactlessly. They detect objects independent of their characteristics (e.g., shape, color, surface structure, material). The basic operating principle is based on the transmission and reception of light. There are three different versions: 1. The through-beam sensor consists of two separate devices, a transmitter and a receiver that are aligned with one another. If the light beam between the two devices is interrupted, the switching output integrated in the receiver changes its status. 2. With the retro-reflective sensor, the transmitter and receiver are located in one device. The emitted light beam is reflected back to the receiver by a reflector that is to be mounted opposite the device. As soon as the light beam is interrupted, the switching output integrated in the device changes its status. 3. With the diffuse reflection sensor, the transmitter and receiver are in one device. The emitted light beam is reflected by the object that is to be detected. As soon as the receiver detects the reflected light, the switching output integrated in the device changes its status.



MECHANICAL DATA

Ambient temperature	-20 °C ... 50 °C
Degree of protection (IP)	IP67
Housing coating	Anodised
Housing design	Cuboid
Housing material	Aluminium
Material of optical surface	Glass
Sensor height	34 mm
Sensor length	99 mm
Sensor width	34 mm
Storage temperature	85 °C
Storage temperature	-20 °C

ELECTRICAL DATA

Analogue output 4 mA ... 20 mA	Yes
Equipment protection class	Protection class 3
IO-Link compatible	No
Max. output current	100 mA
Max. switching distance	5000 mm
Measurement frequency	25000 Hz
Measuring range	5 m
No-load current	30 mA
Number of pins	4
Operating voltage	12 V ... 32 V
Rated switching distance	5000 mm
Relative repeat accuracy	200 µm
Reverse polarity protection	Yes
Setting procedure	Manual adjustment

ELECTRICAL DATA

Short-circuit-proof	Yes
Switching frequency	25000 Hz
Type of analog output	4 mA ... 20 mA
Type of electrical connection	M12-connector
Type of input voltage	DC
Type of switching function	Push-pull
Type of switching output	PNP/NPN
Voltage type	DC
With LED display	Yes
With LED display (operation)	Yes
With LED display (signal)	Yes

OPTICAL DATA

Aperture length	20 mm
Aperture width	0.3 mm
Filter	Interference / polarizing filter
Laser protection class	Class 1
Light beam form	Line
Wavelength of the sensor	670 nm

OTHER DATA

Scope of delivery of the one-way system	Receiver
---	----------

CONNECTION

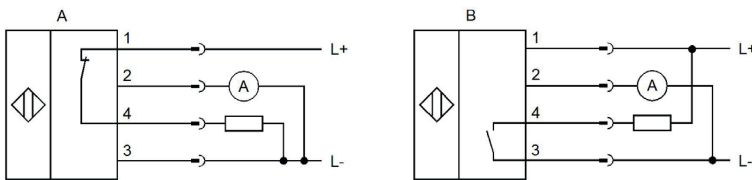

Colors: A: 1 = BN (brown), 2 = WH (white), 3 = BU (blue), 4 = BK (black)

B: 1 = BN (brown), 2 = WH (white), 3 = BU (blue), 4 = BK (black) **Functions:** A: 1 = L+, 2 = 4-20mA, 3 = L-, 4 = PNP NC

B: 1 = L+, 2 = 4-20mA, 3 = L-, 4 = NPN NO

DIMENSIONAL DRAWING

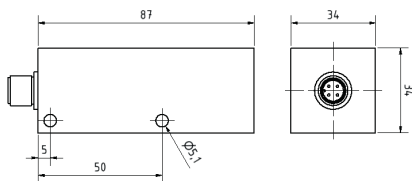

INSTALLATION

DISPOSAL



Mounting / Installation may only be carried out by a qualified electrician!



SAFETY WARNINGS

Before initial operation, please make sure to follow all safety instructions that may be provided in the product information!