

## PSSI0169

### LASER SENSORS • LINE SENSORS TRANSMITTERS

Optical sensors function contactlessly. They detect objects independent of their characteristics (e.g., shape, color, surface structure, material). The basic operating principle is based on the transmission and reception of light. There are three different versions: 1. The through-beam sensor consists of two separate devices, a transmitter and a receiver that are aligned with one another. If the light beam between the two devices is interrupted, the switching output integrated in the receiver changes its status. 2. With the retro-reflective sensor, the transmitter and receiver are located in one device. The emitted light beam is reflected back to the receiver by a reflector that is to be mounted opposite the device. As soon as the light beam is interrupted, the switching output integrated in the device changes its status. 3. With the diffuse reflection sensor, the transmitter and receiver are in one device. The emitted light beam is reflected by the object that is to be detected. As soon as the receiver detects the reflected light, the switching output integrated in the device changes its status.



#### MECHANICAL DATA

Ambient temperature	-10 °C ... 50 °C
Degree of protection (IP)	IP54
Housing coating	Anodised
Housing design	Cuboid
Housing material	Aluminium
Reflector included in the scope of delivery	No
Sensor height	70 mm
Sensor length	24 mm
Sensor width	84 mm

#### ELECTRICAL DATA

Input (TeachIn)	Yes
IO-Link compatible	No
Max. output current	100 mA
Measuring range	2 m
No-load current	200 mA
Number of pins of the communication interface, transmitter + receiver	3
Operating voltage	24 V ... 24 V
Rated switching distance	2000 mm
Relative repeat accuracy	8 µm
Setting procedure	Parameterization
Short-circuit-proof	Yes
Switching frequency	2000 Hz
Type of communication interface, transmitter + receiver	Connector M9
Type of input voltage	DC
Type of plug-in contact, communication interface	Female (socket)
Voltage type	DC

## ELECTRICAL DATA

With time function	No
--------------------	----

## OPTICAL DATA

Aperture length	16 mm
Filter	Interference filter
Laser class	2
Laser protection class	Class 1
Light beam form	Line
Light source	Laser diode, red light
Line sensor	Yes

## OTHER DATA

Scope of delivery of the one-way system	Transmitter
---	-------------

## CONNECTION

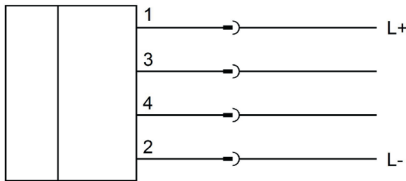

## DIMENSIONAL DRAWING

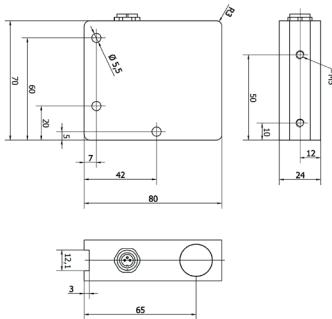

## INSTALLATION



Mounting / Installation may only be carried out by a qualified electrician!

## DISPOSAL



## SAFETY WARNINGS

Before initial operation, please make sure to follow all safety instructions that may be provided in the product information!