

VK255C44

CONNECTION TECHNOLOGY • CABLE SOCKETS /CONNECTORS ONE-SIDED PRE-ASSEMBLED

ipf cable sockets are used primarily for establishing the electrical connection of sensors. Their features are characterized by rugged design, the highest protection classes (IP67 | IP68 | IP69K) and, if desired, with 360° shielding. With the features: bus-ready, suitable for use with drag chains and robots, resistance to oil and chemicals, resistance to welding sparks, their resistance to cleaning agents or high-pressure and steam-jet cleaning, the expanded temperature range of up to +230°C, the rapid interconnection technology and special data transmission properties, the cable sockets meet all requirements in automation technology.

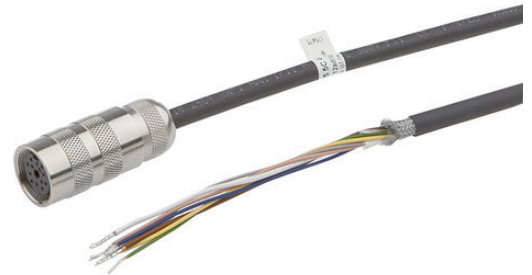

MECHANICAL DATA

Ambient temperature	-5 °C ... 70 °C
Cable length	2.5 m
Degree of protection (IP)	IP67
Material of cable sheath	Other
Number of wires	12
Positioning of cable feed, field side	Straight
Positioning of cable feed, housing side	Straight

ELECTRICAL DATA

Nominal supply voltage	300 V
Number of pins	12
Rated voltage	300 V
Shielded	Yes
Type of electrical connection, field side	Free conductor end
Type of electrical connection, housing side	M16
Type of plug-in contact, housing side	Female (socket)

OTHER DATA

Flame resistant	Yes
IR-networked	No
Oil and cooling lubricants	Yes
Suitable for trailing chain and torsion resistant	Yes

CONNECTION

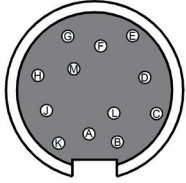

DIMENSIONAL DRAWING

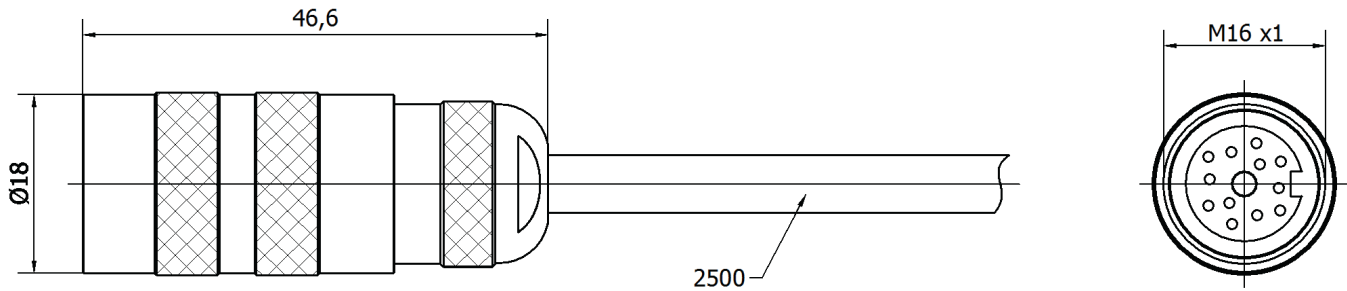

INSTALLATION



Mounting / Installation may only be carried out by a qualified electrician!

DISPOSAL



SAFETY WARNINGS

Before initial operation, please make sure to follow all safety instructions that may be provided in the product information!