

# FIFE SE-11 INFRARED SENSOR

# MAXCESS®

MAGPOWR



TIDLAND

The SE-11 is the smallest of our infrared sensors. Its compact size and light weight make this sensor ideal for applications where accuracy is required, but space is limited. The SE-11 has a standard sensing gap of 25.4 mm (1 inch), a control range of 5 mm (0.20 inch), and is available in a 1% temperature compensated version.

The optical design of the SE-11 allows for output linear to the web position in the control range, making it virtually unaffected by plane change. When used with Fife web guide controllers, the SE-11 is capable of guiding clear films with an opacity <10%.



## GENERAL SPECIFICATIONS

<b>Product Name</b> SE-11 Infrared Sensor	<b>Power Required</b> 10 to 15 VDC at 30 mA
<b>Linearity</b> 1.5% nominal maximum error	<b>Output Signal</b> 0 to 10 mA
<b>Plane Change</b> 1.5% nominal maximum error	<b>Weight</b> 140 grams (5 ounces)
<b>Temperature Drift</b> 1% maximum error (SE-11-IT) 5° to 50° C (41° to 122° F)	<b>Temperature Range</b> 0° to 50° C (32° to 122° F)

## KEY FEATURES

- Smallest, most compact infrared sensor available
- Immune to web plane changes and unaffected by ambient light, including sunlight
- Modulated infrared light will not affect photosensitive paper/film
- Compatible with all Fife controllers
- Standard sensing gap of 25.4 mm (1 inch) with a control range of 5 mm (0.20 inch)
- Flexible mounting and positioning assemblies ensure quick and easy installation
- Electrostatic discharge protection
- Built-in air sweep connection

# FIFE SE-11 INFRARED SENSOR

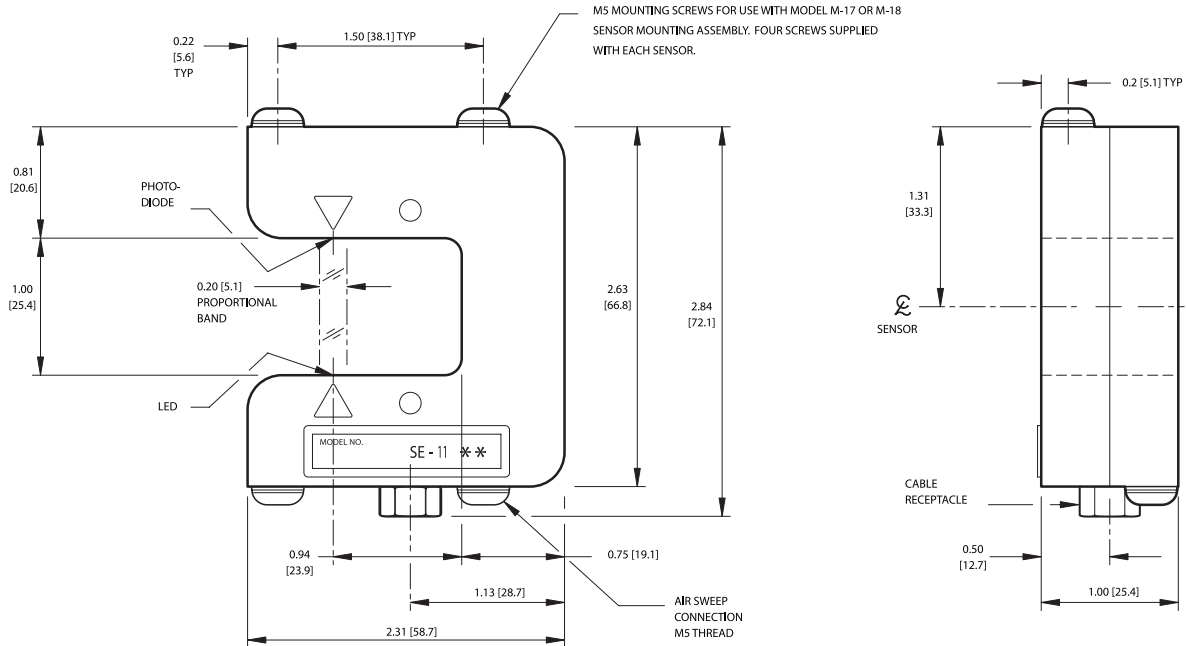

Dimensions shown in parenthesis are in millimeters

SENSOR MOUNTING	SQUARE BAR		A	B	C
	SIZE	MAXIMUM LENGTH			
M-17	19.05 mm (0.75 inch)	1524.00 mm (60.00 inches)	49 mm (1.94 inches)	38.10 mm (1.50 inches)	16.00 mm (0.63 inches)
M-18	25.4 mm (1 inch)	2184.40 mm (86.00 inches)	52 mm (2.06 inches)	50.80 mm (2.00 inches)	19.05 mm (0.75 inch)

## THE SE-11 IS AVAILABLE IN TWO MODELS

- SE-11-IC - Current out less than 5% temperature coefficient.
- SE-11-IT - Current out less than 1% temperature coefficient.

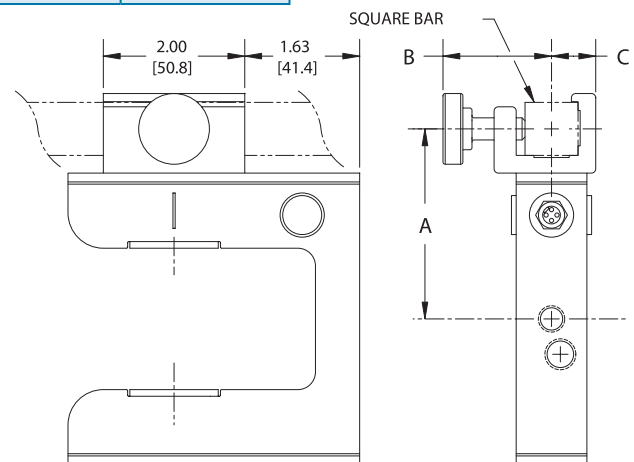

# MAXCESS®



## NORTH, CENTRAL AND SOUTH AMERICA

Tel +1.405.755.1600  
Fax +1.405.755.8425  
sales@maxcessintl.com  
www.maxcessintl.com

## INDIA

Tel +91.22.27602633  
Fax +91.22.27602634  
india@maxcessintl.com  
www.maxcess.in

## EUROPE, MIDDLE EAST AND AFRICA

Tel +49.6195.7002.0  
Fax +49.6195.7002.933  
sales@maxcess.eu  
www.maxcess.eu

## JAPAN

Tel +81.43.421.1622  
Fax +81.43.421.2895  
japan@maxcessintl.com  
www.maxcess.jp

## CHINA

Tel +86.756.881.9398  
Fax +86.756.881.9393  
info@maxcessintl.com.cn  
www.maxcessintl.com.cn

## KOREA, TAIWAN AND SE ASIA

Tel +65.9620.3883  
Fax +65.6235.4818  
asia@maxcessintl.com