

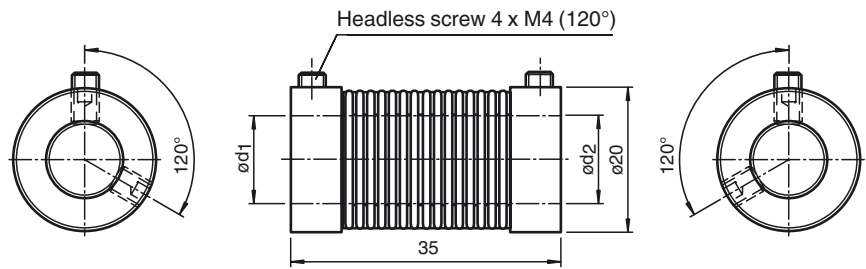

## Dimensions



## Model Number

**9409 6\*10**

Bellows coupling

## Features

- Backlash-free, angle synchronous rotation transmission
- Very high torsion spring stiffness
- Material stainless steel and anodized aluminum

## Technical data

### Ambient conditions

Ambient temperature -30 ... 120 °C (-22 ... 248 °F)

### Mechanical specifications

Shaft diameter  $d1 = 6 \text{ mm}$ ,  $d2 = 10 \text{ mm}$

### Material

Flange anodized aluminum

Bellows Stainless steel

Mass approx. 16 g

Rotational speed max. 10000 min<sup>-1</sup>

Max. torque 1 Nm

Tightening torque, fastening screws 1.5 Nm

Radial offset max. ± 0.3 mm

Axial offset max. ± 0.5 mm

Angle error max. ± 4 °

Torsion spring stiffness 140 Nm / rad

Radial spring stiffness 10 N / mm

Moment of inertia 9 g cm<sup>2</sup>