



**Model Number**

**SB4 Housing 2**

Empty housing for Evaluation unit SB4

**Features**

- Housing of the SafeBox with backplane for completion

**Dimensions**

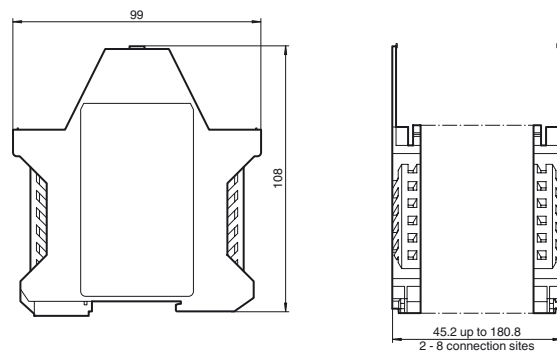

**Technical data**

**Mechanical specifications**

Material Polyamide (PA)

**Approvals and certificates**

Approvals TÜV, cULus

**Model number**

Number of plug-in stations	Description	Housing width (mm)
2	SB4 Housing 2	45.2
3	SB4 Housing 3	67.8
4	SB4 Housing 4	90.4
5	SB4 Housing 5	113.0
6	SB4 Housing 6	135.6
7	SB4 Housing 7	158.2
8	SB4 Housing 8	180.8

Release date: 2018-09-26 11:15 Date of issue: 2018-09-26 191465\_eng.xml

Refer to "General Notes Relating to Pepperl+Fuchs Product Information".

Pepperl+Fuchs Group  
www.pepperl-fuchs.com

USA: +1 330 486 0001  
fa-info@us.pepperl-fuchs.com

Germany: +49 621 776 4411  
fa-info@de.pepperl-fuchs.com

Singapore: +65 6779 9091  
fa-info@sg.pepperl-fuchs.com