

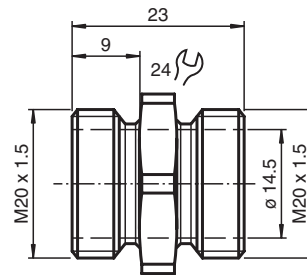

Dimensions



Technical data

Mechanical specifications

Material	metal
Mass	approx. 27 g
Dimensions	23 x 26.5 mm

Features

- Accessory for WirelessHART Adapter
- M 20

Function

This mounting set allows to mount the WirelessHART Adapter WHA-ADP-F8B2-* to a pole or a wall. Through the modular construction, the pole can be horizontal or vertical.

The dimensions are optimized to bring the antenna of WirelessHART Adapter far away from the wall or the pole in order to minimize interference of radio communication.