

## Datasheet - AZ 16-12ZI-B1

Safety switch with separate actuator / AZ 16ZI / AZ 16ZI-B1

☒ Preferred typ

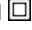

- Thermoplastic enclosure
- Individual coding
- Coding level "High" according to ISO 14119
- 52 mm x 90 mm x 30 mm
- Long life
- Double-insulated 
- Large wiring compartment
- High level of contact reliability with low voltages and currents
- Insensitive to soiling
- Slotted holes for adjustment, circular holes for location
- 3 cable entries M 16 x 1.5

(Minor differences between the printed image and the original product may exist!)

### Ordering details

Product type description	AZ 16-12ZI-B1
Article number	101150050
EAN Code	4030661154442
eCI@ss	27-27-26-02

### Approval

Approval



### Classification

Standards	EN ISO 13849-1
B10d Normally-closed contact (NC)	2.000.000
B10d Normally open contact (NO)	1.000.000
- notice	at 10% I <sub>e</sub> and ohmic load
Mission time	20 Years
notice	$MTTF_d = \frac{B_{10d}}{0,1 \times n_{op}}$ $n_{op} = \frac{d_{ap} \times h_{op} \times 3600 \text{ s/h}}{t_{cycle}}$

Global Properties

Permanent light	AZ 16ZI
Standards	EN 60947-5-1, BG-GS-ET-15
Materials	
- Material of the housings	Plastic, glass-fibre reinforced thermoplastic, self-extinguishing
- Material of the actuator	Stainless steel
- Material of the contacts	Silver
Housing coating	None
Weight	156

Mechanical data

Design of electrical connection	Screw connection
Cable section	
- Min. Cable section	0,75
- Max. Cable section	2.5
Design of actuators	straight, rigid
Mechanical life	> 1.000.000 operations
notice	All indications about the cable section are including the conductor ferrules.
With ejection force (Y/N)	Yes
Positive break force	20
positive break travel	8 mm
Actuating speed	max. 2 m/s
Minimum actuating radius	250 mm

Ambient conditions

Ambient temperature	
- Min. environmental temperature	-30 °C
- Max. environmental temperature	+80 °C
Protection class	IP67 to IEC/EN 60529

Electrical data

Design of control element	Normally open contact (NO), Opener (NC)
Switching principle	Creep circuit element
Number of auxiliary contacts	1
Number of safety contacts	2
Rated impulse withstand voltage U <sub>imp</sub>	6 kV
Rated insulation voltage U <sub>i</sub>	500 V
Thermal test current I <sub>the</sub>	10 A
Utilisation category	AC-15: 230 V / 4 A, DC-13: 24 V / 4 A
Max. fuse rating	6 A gG D-fuse

ATEX

Explosion protection categories for gases	None
Explosion protected category for dusts	None

Dimensions

Dimensions of the sensor	
--------------------------	--

- Width of sensor	52 mm
- Height of sensor	90
- Length of sensor	30 mm

### notice



Minimum actuating radius on hinged guards 250 mm  
The axis of the hinge should be 5 mm above the top edge of the safety switch and in the same plane  
The actuator is not available separately.

### Included in delivery

Individually coded actuator  
tamperproof screws  
Slot sealing plugs

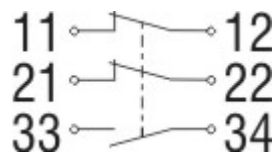

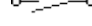
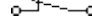

### Diagram

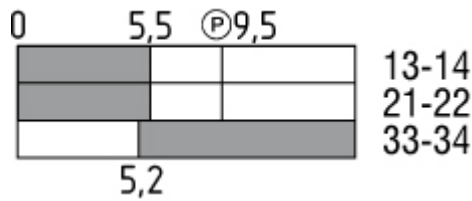

Note Diagram  
 positive break NC contact  
 active  
 no active  
 Normally-open contact  
 Normally-closed contact

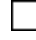
### Switch travel diagram



Notes Switch travel diagram  
 Contact closed  
 Contact open  
 Setting range  
 Break point  
 Positive opening sequence/- angle  
**VS** adjustable range of NO contact  
**VÖ** adjustable range of NC contact  
**N** after travel

### Ordering suffix

The applicable ordering suffix is added at the end of the part number of the safety switch.  
Order example: AZ 16-12ZI-B1-**1762**

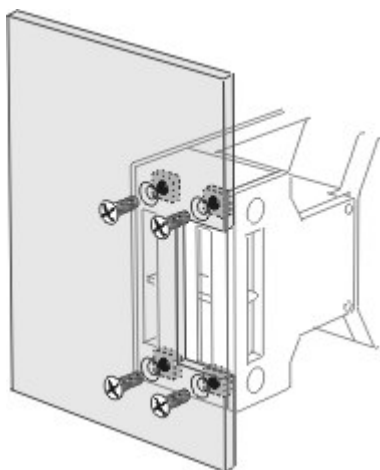

....-1762

....-1637

....-M20

Versions with M5 nuts  
For front mounting of safety switch, e.g. on sheet-steel covers  
Cannot be retrofitted

0,3 µm gold-plated contacts

cable entries M20

## Ordering code

---

AZ 16-(1)ZI-(2)-(3)

(1)

3.0

12

(2)

B1

B1-1747

B1-2024

B1-2053

B1-2177

(3)

M16

M20

3 Opener (NC)

1 Normally open contact (NO) / 2 Opener (NC)

### Actuator:

straight Design

straight Design with magnetic latch

straight Design with slot sealing plug

straight Design with ball latch

straight Design with centering guide

Cable entry M16

Cable entry M20

## Documents

---

**Operating instructions and Declaration of conformity (jp)** 732 kB, 20.01.2017

Code: mrl\_az16zi\_jp

**Operating instructions and Declaration of conformity (nl)** 492 kB, 02.08.2018

Code: mrl\_az16zi\_nl

**Operating instructions and Declaration of conformity (it)** 465 kB, 21.11.2016

Code: mrl\_az16zi\_it

**Operating instructions and Declaration of conformity (pt)** 452 kB, 04.12.2015

Code: mrl\_az16zi\_pt

**Operating instructions and Declaration of conformity (da)** 361 kB, 25.01.2012

Code: mrl\_az16zi\_da

**Operating instructions and Declaration of conformity (en)** 517 kB, 28.09.2016

Code: mrl\_az16zi\_en

**Operating instructions and Declaration of conformity** (de) 515 kB, 28.09.2016

Code: mrl\_az16zi\_de

**Operating instructions and Declaration of conformity** (ro) 362 kB, 25.01.2012

Code: mrl\_az16zi\_ro

**Operating instructions and Declaration of conformity** (fr) 468 kB, 18.11.2016

Code: mrl\_az16zi\_fr

**Operating instructions and Declaration of conformity** (es) 471 kB, 21.11.2016

Code: mrl\_az16zi\_es

**Operating instructions and Declaration of conformity** (cn) 609 kB, 11.05.2017

Code: mrl\_az16zi\_cn

**Operating instructions and Declaration of conformity** (sv) 343 kB, 17.06.2015

Code: mrl\_az16zi\_sv

**Operating instructions and Declaration of conformity** (pl) 503 kB, 01.12.2016

Code: mrl\_az16zi\_pl

**BG-test certificate** (en) 536 kB, 05.01.2011

Code: z\_\_16p02

**BG-test certificate** (de) 203 kB, 02.03.2016

Code: z\_\_16p01

**CCC certification** (cn) 3 MB, 18.10.2017

Code: q\_175p03

**CCC certification** (en) 3 MB, 29.08.2017

Code: q\_175p02

## Images

---

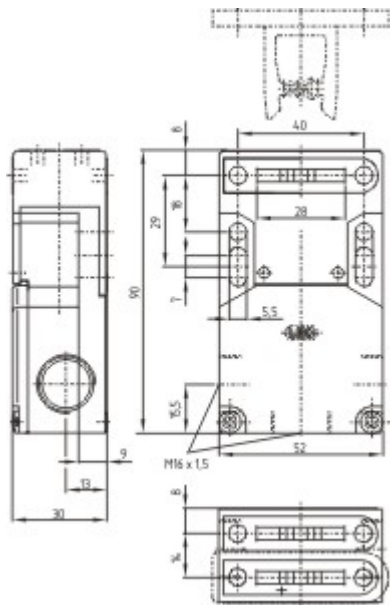

Dimensional drawing (basic component)

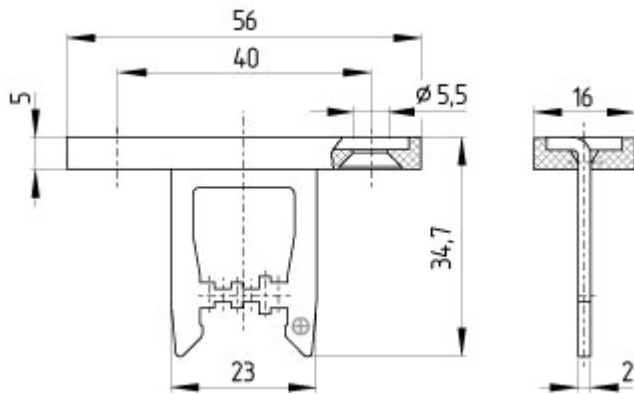

Dimensional drawing (miscellaneous)

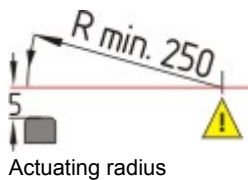
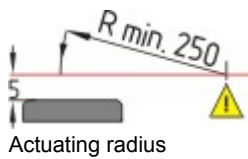

## System components

### Mounting accessories



#### 1135338 - TAMPERPROOF SCREWS M 5 x 12

- To mount the actuator
- Higher protection against tampering with interlock
- Protects against unauthorised removal of actuator
- Various lengths available



#### 101135339 - TAMPERPROOF SCREWS M 5 x 16

- To mount the actuator
- Higher protection against tampering with interlock
- Protects against unauthorised removal of actuator
- Various lengths available



#### 101135340 - TAMPERPROOF SCREWS M 5 x 20

- To mount the actuator
- Higher protection against tampering with interlock
- Protects against unauthorised removal of actuator
- Various lengths available