

## Datasheet - SE-P40-NBR-1250

Safety-related tactile sensor / Safety edges / SE-P40



☒ Preferred typ

- Dirt and moisture in the profile are to a great extent compensated
- Insensitive to environmental conditions
- approx. 40 mm high



(Minor differences between the printed image and the original product may exist!)

### Ordering details

Product type description	SE-P40-NBR-1250
Article number	101174453
EAN Code	4030661303727
A safety edge system consists of individual components. The components must be ordered separately.	
Example:	
Rubber profile, SE-P40-1250	
Al profile, SE-AL 10-1250	
Emitter/ Receiver SE-SET	
Safety-monitoring module, SE-304 C	
Options:	
Caps SE-T40; Sticker SE-G8406	
Other accessories	
eCl@ss	27-27-34-01

### Global Properties

Permanent light	Gummiprofil SE-P40
Standards	EN ISO 13850
Compliance with the Directives (Y/N)	No
Materials	
- Material of the rubber profile	NBR perbunan®
Weight	710
Coated profile (Y/N)	No

Mechanical data

Mechanical life	20.000.000 operations
max. permanent load	500 on the operational switching zone
Response travel	max. 9 mm
After-travel	max. 18 mm

Ambient conditions

Protection class	IP67
notice	The protection class IP 67 applies to the entire signal transmitter.

Dimensions

Dimensions	
- Width	25 mm
- Height	approx. 40 mm
- Length	1250 mm

notice

In the extremities of the safety edge at approx. 60 mm (SE 40) or 50 mm (SE 70) finger guard is not guaranteed. Upon actuation of this area, the transmitter/receiver is pushed into the lower profile section and the switching signal is evaluated, but the required forces are high though. If this restriction is not acceptable for the specific application, constructive measures must be taken.

Ordering code

SE-P40 (1)-(2)-(3)	
(1)	
without	Profile uncoated
C	Profile coated
(2)	
without	Material: EPDM, 65 Shore A
NBR	Material: perbunan® NBR
(3)	
1250	Length 1250 mm
2500	Length 2500 mm
5000	Length 5000 mm (Only for Profile uncoated)
10000	Length 10000 mm (Only for Profile uncoated)

Documents

Operating instructions and Declaration of conformity (jp) 263 kB, 09.09.2014  
Code: mrl\_se40-70\_jp

Operating instructions and Declaration of conformity (fr) 218 kB, 03.12.2014  
Code: mrl\_se40-70\_fr

Operating instructions and Declaration of conformity (it) 219 kB, 28.08.2014  
Code: mrl\_se40-70\_it

Operating instructions and Declaration of conformity (de) 205 kB, 29.07.2014

Code: mrl\_se40-70\_de

**Operating instructions and Declaration of conformity** (cn) 258 kB, 24.06.2015

Code: mrl\_se40-70\_cn

**Operating instructions and Declaration of conformity** (es) 221 kB, 28.08.2014

Code: mrl\_se40-70\_es

**Operating instructions and Declaration of conformity** (nl) 201 kB, 16.10.2014

Code: mrl\_se40-70\_nl

**Operating instructions and Declaration of conformity** (en) 203 kB, 29.07.2014

Code: mrl\_se40-70\_en

**Mounting and wiring instructions** (de, en, fr) 30 kB, 30.04.2009

Code: m\_se\_p03

**Force-travel diagram** (en) 106 kB, 14.08.2009

Code: k\_se\_p02

**Force-travel diagram** (fr) 81 kB, 14.08.2009

Code: k\_se\_p03

**Force-travel diagram** (pt) 73 kB, 14.08.2009

Code: k\_se\_p10

**Force-travel diagram** (nl) 72 kB, 14.08.2009

Code: k\_se\_p04

**Force-travel diagram** (it) 72 kB, 14.08.2009

Code: k\_se\_p05

**Force-travel diagram** (es) 72 kB, 14.08.2009

Code: k\_se\_p09

**Force-travel diagram** (de) 105 kB, 14.08.2009

Code: k\_se\_p01

## Images

---



Product photo

---

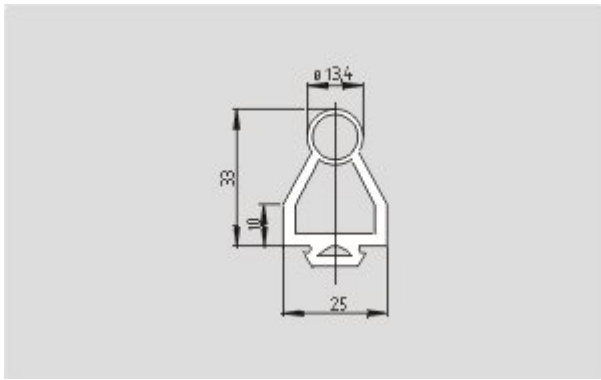

Dimensional drawing (basic component)

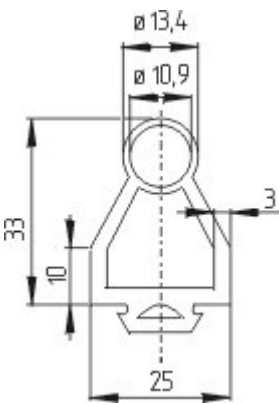

Dimensional drawing (basic component)