

Datasheet - BN 75-11Y

Magnetic reed switch / BN 75

☒ Preferred typ



- with connector
- Non-contact principle
- 1 Reed kontakts
- Long life
- 80 mm x 99,5 mm x 55 mm
- Float switch
- Thermoplastic enclosure
- Available with M12 plug-in connector and pre-wired cable

(Minor differences between the printed image and the original product may exist!)

Ordering details

Product type description	BN 75-11Y
Article number	101055701
EAN Code	4030661008981
eCl@ss	27-27-01-04

Approval

Approval	-
----------	---

Global Properties

Permanent light	BN 75
Standards	-
Compliance with the Directives (Y/N) 	Yes
Active principle	Magnetic drive
Materials	
- Material of the housings	Plastic, glass-fibre reinforced thermoplastic
- Material of the active surface	Plastic
Housing construction form	Special construction
Weight	74

Mechanical data

Design of electrical connection	connector
Mechanical life	1.000.000.000 operations
Electrical lifetime	1.000.000 ... 1.000.000.000 operations
hysteresis	3 mm
Type of actuation	Magnet
restistance to shock	-
Bounce duration	0,2 ... 0,5
Latching (Y/N)	No
bias magnet (Y/N)	No

Ambient conditions

Ambient temperature	
- Min. environmental temperature	-25
- Max. environmental temperature	+80
Protection class	IP65

Electrical data

Design of control element	Normally open contact (NO) / Opener (NC)
Number of change-over contact	1
Number of shutters	1
Number of openers	1
Voltage type	
Dielectric strength	> 350 (50)
Switching voltage	220
Switching current	1 A
Switching capacity	60 /

Outputs

Design of control output	Reed kontakts
--------------------------	---------------

LED switching conditions display

LED switching conditions display (Y/N)	No
--	----

ATEX

Explosion protection categories for gases	None
Explosion protected category for dusts	None

Dimensions

Dimensions of the sensor	
- Width of sensor	80
- Height of sensor	99.5
- Length of sensor	55

notice

Depending on how the floater is assembled, either a NO contact or a NC contact is possible.

The indicated switching points are applicable for water

The switching function is reversed accordingly, if the floater in a changeover contact element is turned upside-down. The operating points listed, apply for water.

Diagram

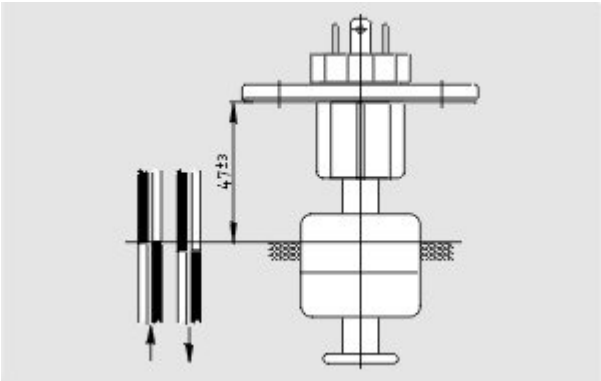

- Note Diagram
- positive break NC contact
 - active
 - no active
 - Normally-open contact
 - Normally-closed contact

Documents

Declaration of conformity (en) 186 kB, 12.07.2018
Code: __bn_p01_en

Declaration of conformity (de) 102 kB, 08.06.2016
Code: __bn_p01

Images

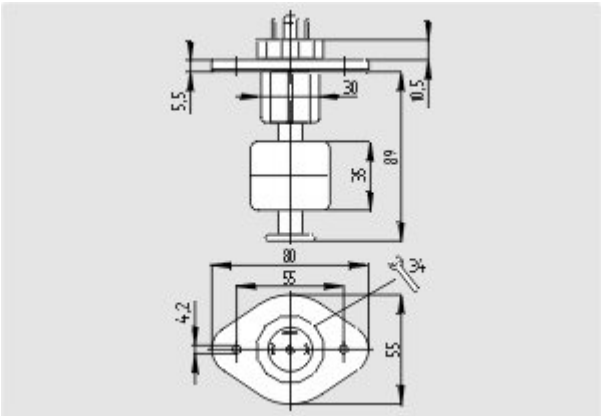

Dimensional drawing (basic component)

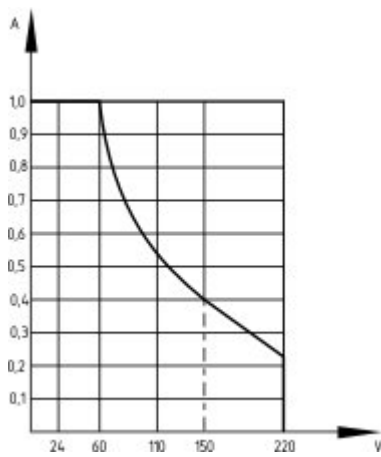

Characteristic curve

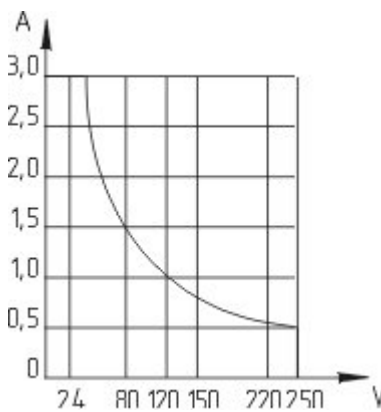

Characteristic curve